

# Access door

# TLU

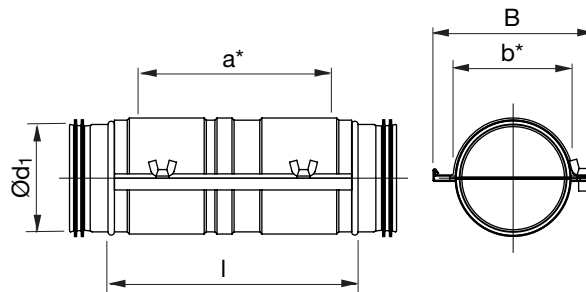

## Dimensions



## Description

Locked with hexagon bolts.  
Can achieve maximum tightness class C.

Ød <sub>1</sub> nom	l mm	a* mm	b* mm	B mm	m kg
80	307	187	80	140	0,59
100	307	187	100	160	0,68
125	307	187	125	185	0,80
160	307	187	160	220	1,00
200	307	187	200	260	1,38
250	382	232	250	310	2,00
315	452	304	315	375	2,80

\*Note! Opening dimensions.

## Ordering example

