

# Slide-in female coupling

# SMFU

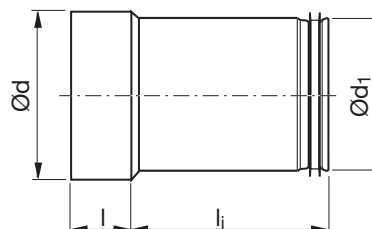

## Dimensions



## Description

### Areas of use:

- To avoid the necessity of an exact length cutting of a duct when it is difficult to take a proper measure. E.g. the connection of a duct to a stub on an air supply terminal. In this case the slide-in coupling shall be secured with screws or pop rivets.
- To make it possible to use a duct that is cut to a too short length – instead of having to cut a new duct to the correct length. In this case the slide-in coupling shall be secured with screws or pop rivets.
- To eliminate or minimize the number of ordinary duct cuttings at building site – together with pre-cut ducts of shorter lengths. In this case the slide-in coupling shall be secured with screws or pop rivets.
- To assist when inserting or adding an other product into an existing system. E.g. the cutting-in of an extra silencer. In this case the slide-in coupling shall be secured with screws or pop rivets.
- To assist when removing an other product when cleaning a system. E.g. the removal of a damper with a obstructionable blade. Lindab do not recommend this use of larger dimensions than Ø315.
- To facilitate access when inspecting and/or cleaning a system – by simply sliding the coupling. The coupling acts as an access cap. Lindab do not recommend this use of larger dimensions than Ø315.
- To extend the distance between a T-piece and an access cap, e.g. EPFH or KCU, to get the cap outside any insulation. In this case the slide-in coupling shall be secured with screws or pop rivets only at its female end.

No Click function – has a closed turned-over end and hasn't any notches.

## Ordering example

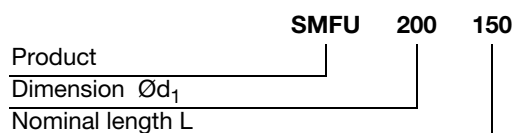

Ød <sub>1</sub> nom	L nom	l mm	l <sub>i</sub> mm	m kg
80	150	40	127	0,16
80	300	40	288	0,30
80	500	40	552	0,65
100	150	40	127	0,20
100	300	40	288	0,38
100	500	40	552	0,81
112	150	40	127	0,23
112	300	40	288	0,43
112	500	40	552	0,93
125	150	40	127	0,25
125	300	40	288	0,47
125	500	40	552	1,01
140	150	40	127	0,28
140	300	40	288	0,53
140	500	40	552	1,13
150	150	40	127	0,29
150	300	40	288	0,57
150	500	40	552	1,21
160	150	40	127	0,31
160	300	40	288	0,60
160	500	40	552	1,29
180	150	40	127	0,35
180	300	40	288	0,68
180	500	40	552	1,45
200	150	40	127	0,49
200	300	40	297	0,96
200	500	40	552	1,67
224	150	40	127	0,55
224	300	40	297	1,08
224	500	40	552	1,87
250	150	60	192	0,90
250	300	60	302	1,28
250	500	60	537	2,10
280	150	60	192	1,02
280	300	60	302	1,44



## Slide-in female coupling

## SMFU

Ød <sub>1</sub> nom	L nom	l mm	l <sub>1</sub> mm	m kg
280	500	60	537	2,36
300	150	60	192	1,10
300	300	60	302	1,55
300	500	60	537	2,53
315 *	150	60	182	1,11
315 *	300	60	297	1,62
315 *	500	60	537	2,64
355 *	150	60	182	1,26
355 *	300	60	297	1,83
355 *	500	60	537	5,00
400 **	300	80	242	2,65
400 **	500	80	500	6,05
450 **	300	80	242	3,04
450 **	500	80	503	7,20
500 **	300	80	242	3,37
500 **	500	80	503	7,69
630 **	300	80	246	5,90
630 **	500	80	502	8,00
800 **	500	100	500	10,6
1000 **	500	120	500	13,7
1250 **	500	120	500	17,1

\* With stiffening bead

\*\* Design with lockseam

1

2

3

4

5

6

7

8

9

10

11

12

13

14

15

16

17

18