

# Accessories

IK



DRHTG



HANDLE



MSATS PPWS, POWS



VREDF 15 60, VREDF 15 100



AXFL



KOMHY



KOMHY LONG



LÖMOK

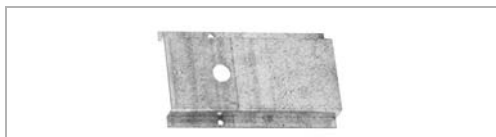

HYLLA PNEU



## Insulation cup IK

If the insulation is thicker than 50 mm, there is a risk that the insulation will cover the knob cup and make it difficult to find or use. The insulation cup allows about 100 mm of insulation to be used at the same time as it gives good access to the damper knob. It is quick and easy to fit - just snap it over the edge of the cup. It fits all Lindab dampers with cup, both circular and rectangular.

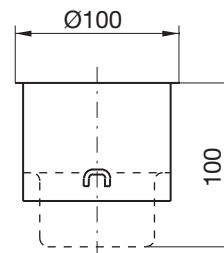

## Handle DRHTG

Strong handle to facilitate setting. Suits all manual dampers.

## Handle HANDLE

Handle suitable for damper with motor shelves DTHU, DTH1U and DTH2U – without motor. Can be used for temporary setting/locking of the damper blade before the motor is mounted or as a permanent alternative to the motor.

Can be set stepless 0–90°. Fits axle 8×8 mm.

Is advisably fixed with one or two sheet metal screws/riquets.

## Assembly kit MSATS PPWS

Kit for installing a pneumatic actuator.

The kit contains all components needed to DTPU 80–400.

## Assembly kit MSATS POWS

Kit for installing a pneumatic actuator.

The kit contains all components needed to DTPU 500–630.

## Extension spindle VREDF 15 60

With a 60 mm long Ø 15 mm spindle. Used for motorizing standard dampers. Fixes to the knob with 2 self-tapping screws.

## Extension spindle VREDF 15 100

With a 100 mm long Ø 15 mm spindle. Used for motorizing standard dampers. Fixes to the knob with 2 self-tapping screws.

## Extension spindle AXFL

A 55 mm long Ø 15 mm spindle. Used for motorizing standard dampers. Fixes to the spindle with a locking screw.

## Installation shelf KOMHY

Hooks to the edge of the cup and blind rivets to the damper body.

## Installation shelf KOMHY LONG

Hooks to the edge of the cup and blind rivets to the damper body.

## Installation shelf LÖMOK

Fixes to the edge of the cup with sheet metal screws.

## Installations shelf HYLLA PNEU

Fixes to DTHU and DTHIU with screws from MSATS.