

# Valve

# KIR

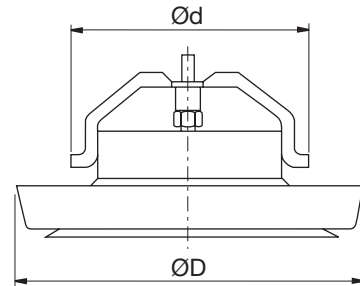

## Dimensions



### Description

Valve for supply air.  
 Designed for ceiling mounting.  
 Equipped with a removable blanking-off sector plate for preventing the air flow in a desired direction.  
 Bayonet holders connect to socket VRGU, VRGL or VRGM.

Ød nom	ØD [mm]	m [kg]
100	135	0,28
125	165	0,44
160	205	0,62

### Materials and finish

#### Material

Coated galvanized sheet metal.

#### Colour

White RAL 9003, gloss 30 or white RAL 9010 gloss30.

### Ordering example

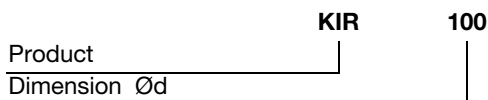

# Valve

# KIR

## Technical data

### Without sector plate

Air flow,  $q$  [l/s] and [m<sup>3</sup>/h], total pressure drop,  $\Delta p_t$  [Pa], throw length,  $l_{0,2}$  [m], and A-weighted sound power level,  $L_{WA}$  [dB], for different settings,  $a$  [mm], are shown in the graphs.

Maximal vertical width,  $b_v$  [m] and Maximal horizontal width,  $b_h$  [m], are shown in the tables.

### Sound power level, $L_{Wok}$ [dB], in octave bands

is calculated as  $L_{WA} + K_{ok}$ .  $K_{ok}$  is found in the table below.

Ød nom	Valve mounted in	Centre frequency [Hz]							
		63	125	250	500	1K	2K	4K	8K
100	Duct	-	-6	-2	-3	-5	-8	-9	-15
125	Duct	-	0	1	-1	-5	-15	-21	-33
160	Duct	-	3	2	-1	-6	-15	-23	-36

Tolerance	-	±3	±2	±2	±2	±2	±2	±2	±3
-----------	---	----	----	----	----	----	----	----	----

### Sound attenuation, $\Delta L$ , [dB]

Ød nom	Valve mounted in	Centre frequency [Hz]							
		63	125	250	500	1K	2K	4K	8K
100	Duct	22	18	13	11	9	8	7	8
125	Duct	20	16	11	9	9	7	6	5
160	Duct	18	14	10	9	9	7	6	6

Tolerance	±6	±3	±2	±2	±2	±2	±2	±2	±3
-----------	----	----	----	----	----	----	----	----	----

### Measurement of air flow

Data is available in a separate brochure.

### Air jet diffusion pattern

Maximal vertical width,  $b_v$  [m]:

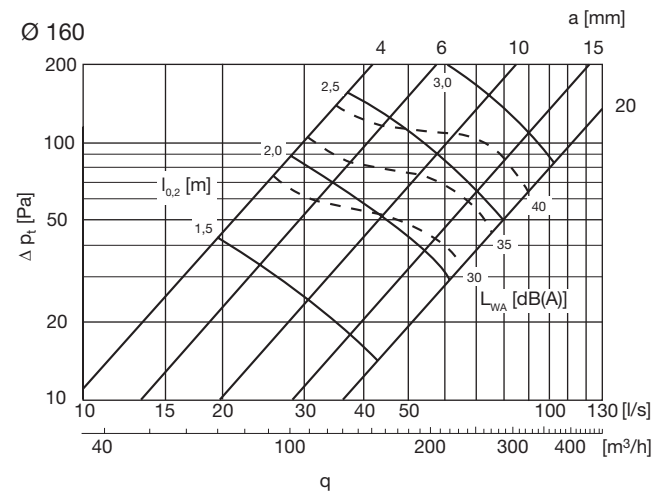
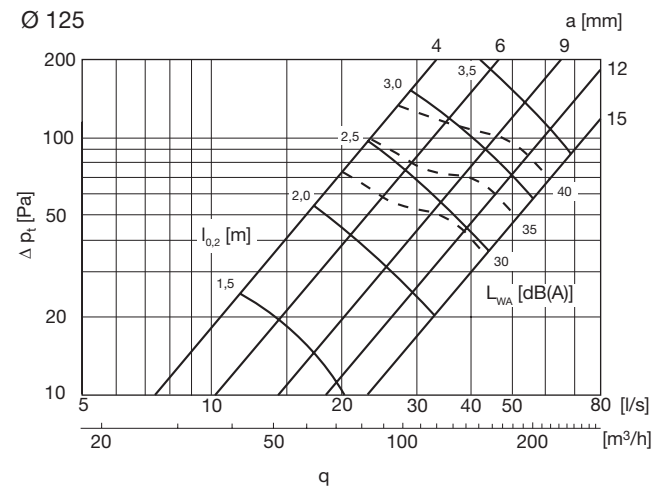
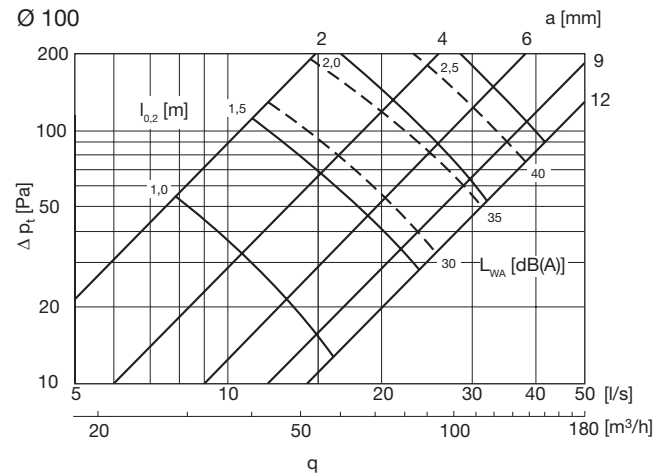

# Valve

# KIR

