

# Z-fastener

# WCZ

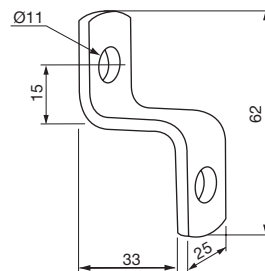

## Dimensions



Thickness		
Dim	mm	Material
25	4	FFZV
25	4	4404

## Description

Bracket in material S250 FFZV.

## Technical data

Max recommended load for different fire classes.

Installation	Ventilation system					Smoke control system
	R0 no fire class kg	R15 kg	R30 kg	R45 kg	R60 kg	600 °C 120 min kg
WCZ	100	100	100	100	100	100

## Ordering example

