

Take-off

VLGUH

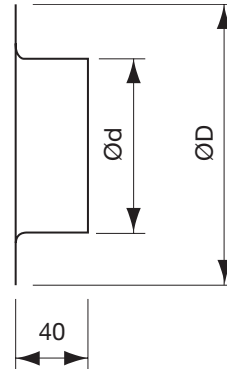

Dimensions



Description

VLGUH is a take-off for wall / floor mounting using E60 ducts in Lindab Safe circular duct system.
Fits on the outside of the duct.
Made of galvanized steel.

Ød [nom]	Ød [mm]	ØD [mm]	m [kg]
80	90	145	0,18
100	110	165	0,22
125	135	190	0,26
160	170	225	0,33
200	210	265	0,40
250	260	315	0,50
315	327	380	0,62
400	412	465	0,78
500	512	565	0,97
*630	645	695	1,22
*800	815	865	1,54

* Handmade

Ordering example

	VLGUH	250
Product		
Dimension Ød		