

# Flexible duct insulation

FDI

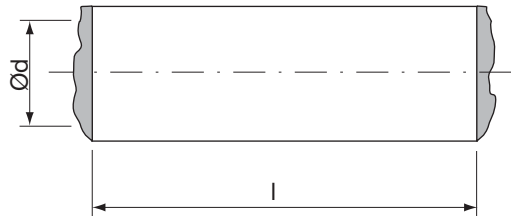

## Dimensions



## Description

Glass wool insulation. The insulation is covered with an outer jacket.

## Applications

The purpose is to insulate a rigid duct.

The insulation reduces the heat gain or loss resulting from a temperature difference between the air flowing in a duct and the surrounding air.

The outer jacket acts as a vapour barrier to prevent condensation to enter into the insulation. Condensation can occur on the outside of a duct carrying air at lower temperatures than the surrounding air.

## Advantages

- Easy assembly, saves installation time.
- Very small storage and transport volume.
- No toxic gases are emitted in case of fire.
- Tested on fire resistance.

## Technical data

Insulation materials:	
insulation.....	Glass wool 25 mm
outer wall (jacket).....	Aluminium-polyester (AP)
Temperature range .....	-30 to +125 °C
Delivery form .....	Flattened
Packing .....	Roll
Standard length.....	5 m

Ød nom	l [mm]
100	5000
125	5000
160	5000
200	5000
250	5000
315	5000

## Ordering example

	<b>FDI</b>	<b>160</b>	<b>5000</b>	<b>AP</b>	<b>25</b>
Product					
Dimension Ød					
Length l					
Material					
Thickness					