

Ventilation grille

F50/F51



Description

The F50 is a circular aluminium grille with square grids. The F51 has exactly the same features and dimensions as the F50, but has pre-drilled holes on the front for installation in ceilings and walls.

The F50/F51 is particularly suitable for air exhaust.

Maintenance

The grille should be removed to enable cleaning of the duct system. The visible parts of the grille can be wiped with a damp cloth.

Materials and finish

Material:	Steel
Grille:	Aluminium
Standard finish:	Powder-coated
Standard colour:	RAL 9003 or 9010 Gloss 30

The grille is available in other colours. Please contact Lindab's sales department for further information.

Order code

Product	Faa	bbb
Type		
F50, F51		
Connection dim.		
Ød 100-630		

Example: F50 - 250

Dimensions

F50

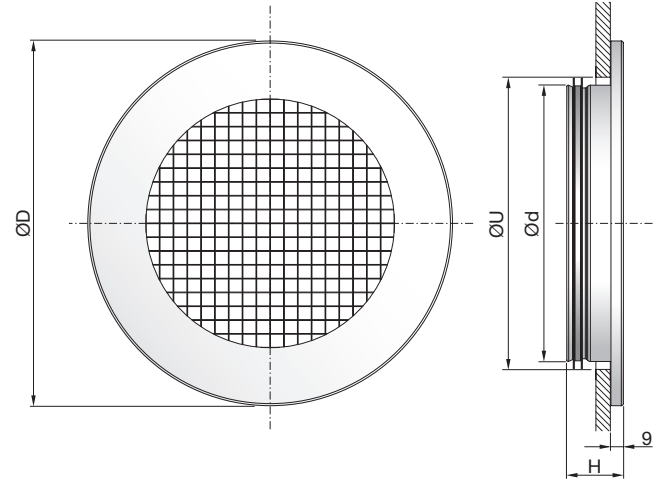

F51

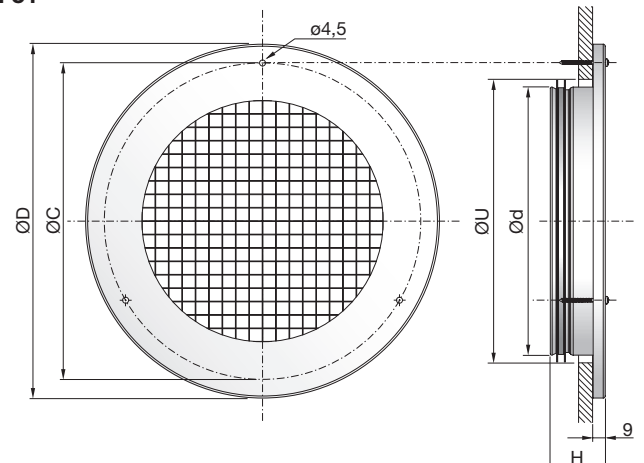

F50/F51	Ød	ØD	ØC*	ØU**	H	Free area A	m
	mm	mm	mm	mm	mm	m²	kg
100	162	136	110	41	0.0047	0.30	
125	187	161	135	41	0.0079	0.40	
160	222	196	170	41	0.0138	0.45	
200	264	236	210	41	0.0216	0.60	
250	314	286	260	61	0.0353	0.80	
315	379	351	325	61	0.0581	1.10	
400	466	436	410	81	0.0944	1.60	
500	566	536	510	81	0.1513	2,00	
630	696	666	640	81	0.2452	2.90	

*ØC only valid for F51 grille.

Ød 100-250, the F51 variant has 3 pre-drilled holes on front for installation.

Ød > 250, the F51 has 4 pre-drilled holes.

The F50 has no pre-drilled holes for installation.

**ØU = Cutting dimension

Ventilation grille

F50/F51

Technical data

Capacity

Volume flow q_v [l/s] and [m³/h], total pressure drop Δp_t [Pa], and sound level L_{WA} [dB(A)] can be seen in the diagrams.

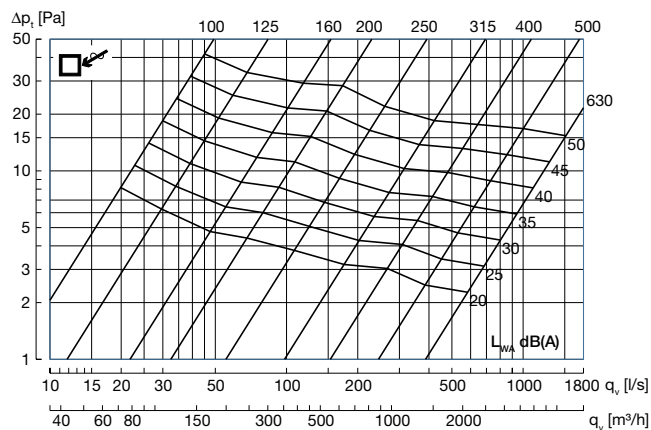

Frequency-related sound power level

The sound power level in the frequency band is defined as

$$L_{WA} + K_{ok}$$

K_{ok} values are given in chart. See table below.

	Centre frequency Hz							
	63	125	250	500	1K	2K	4K	8K
K_{ok}	11	-4	-6	-6	-5	-5	-20	-16