

# Flexible duct insulation

# FDFI

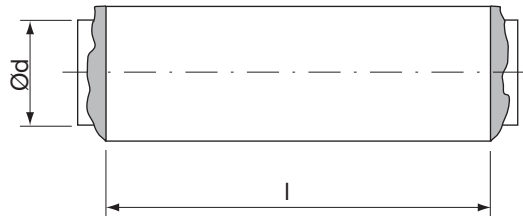

## Dimensions



### Description

Multiple layer Al/PET sleeve encapsulating glass wool insulation with inner PE sleeve.

### Technical data

Duct materials:	
inner wall (core).....	PE
insulation.....	25 mm glass wool
outer wall (jacket).....	Multiple layers aluminium/ polyester
Temperature range .....	-30 to +125 °C
Packing .....	Rolled and strapped

Ød nom	O πd m	A πd <sup>2</sup> /4 m <sup>2</sup>	l [mm]	Max. pressure Pa
80	0,251	0,005	10000	+2000
100	0,320	0,008	10000	+2000
125	0,393	0,012	10000	+2000
160	0,503	0,020	10000	+2000
200	0,628	0,031	10000	+2000
250	0,785	0,049	10000	+2000

### Ordering example

	<b>FDFI</b>	<b>160</b>	<b>10000</b>	<b>AP</b>
Product				
Dimension Ød				
Length l				
Material				