

Lindab

**AD, AR, AE, AC**

Aluminium grilles - Installation instruction

Aluminiums riste - Installations vejledning

Aluminiumgaller - Montageanleitung

Alumiinisäleikot - Asennusohje

Aluminium Lüftungsgitter - Montage Anweisung

Griglie in alluminio - Istruzioni di montaggio

Grilles en aluminium - Instructions de montage

# AD, AR, AE, AC

Overview  
 Oversigt  
 Översikt  
 Yleiskatsaus  
 Übersicht  
 Panoramica  
 Aperçu

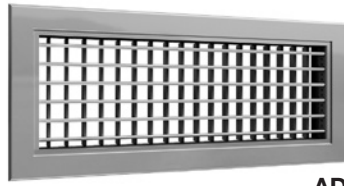

AD

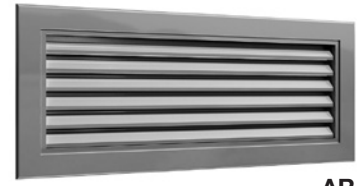

AR



AE

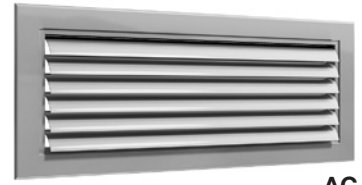

AC

Cutout dimensions  
 Udkæringsmål  
 Ursparning dimensioner  
 Aukkomitat  
 Aussparung  
 Dimensione del foro  
 Cote de réservation

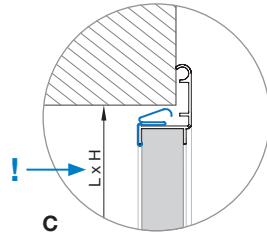

C

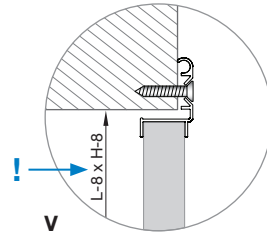

V

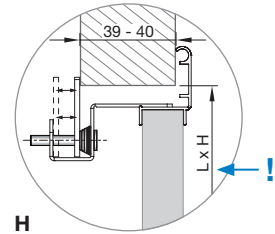

H

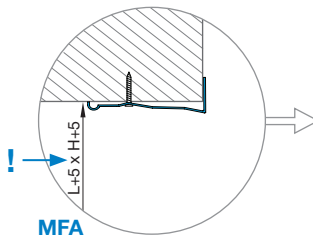

MFA

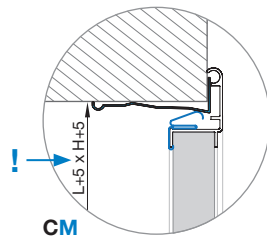

CM

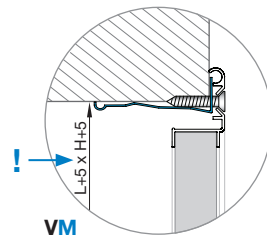

VM

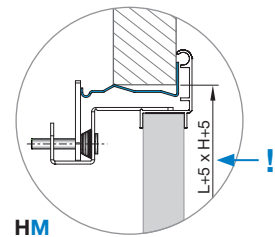

HM

	AD				AR	AE		AC			
	11	12	21	22	11	11	12	11	12	13	14
C											
V											
H	•	•	•	•	-	•	-	•	•	•	•
CM											
VM											
HM	•	•	•	•	-	•	-	•	•	•	•

• Ceilings / Lofters / Tak / Katot / Decken / Soffitti / Plafonds.

■ Walls / Vægge / Väggar / Seinät / Wände / Pareti / Les Murs.

- Not possible / Ikke mulig / Inte tillgänglig / Ei mahdollinen / Nicht möglich / Non possible / Pas possible.

Symbols  
 Symboler  
 Symboler  
 Symbolit  
 Symbole  
 Simboli  
 Symboles



Open damper  
 Åbent spjæld  
 Öppet spjäll  
 Säätöpelti auki  
 Geöffnete Drossel  
 Serranda aperta  
 Registre ouvert



Closed damper  
 Lukket spjæld  
 Stängt spjäll  
 Suljettu säätöpelti  
 Geschlossene Drossel  
 Serranda chiusa  
 Registre fermé

# AD, AR, AE, AC

Accessories  
Tilbehør  
Tillbehör  
Lisävarusteet  
Zubehör  
Accessori  
Accessoires



MFA

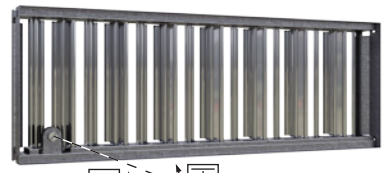

DGA

## MFA (M)

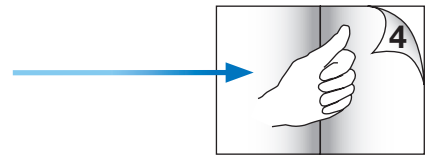

## DGA (D)

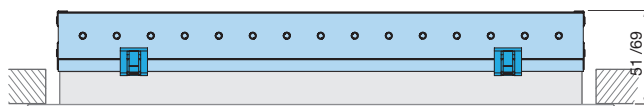
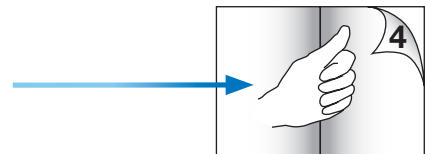
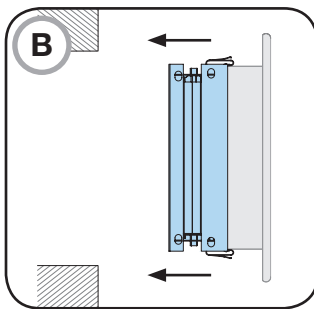
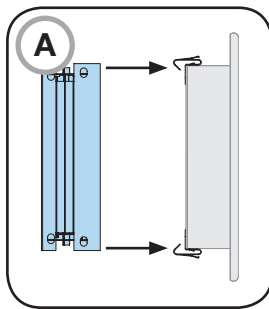

C, V, CM, VM (AD, AR, AE, AC)

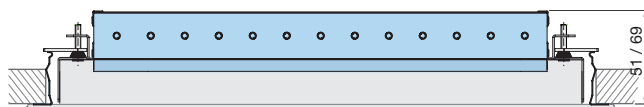

H, HM (AD, AE-11, AC)

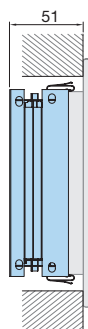

AD-11, 12  
AR-11  
AE-11, 12  
AC-11, 12, 13, 14

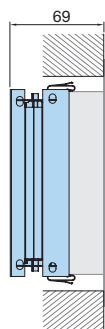

AD-21, 22

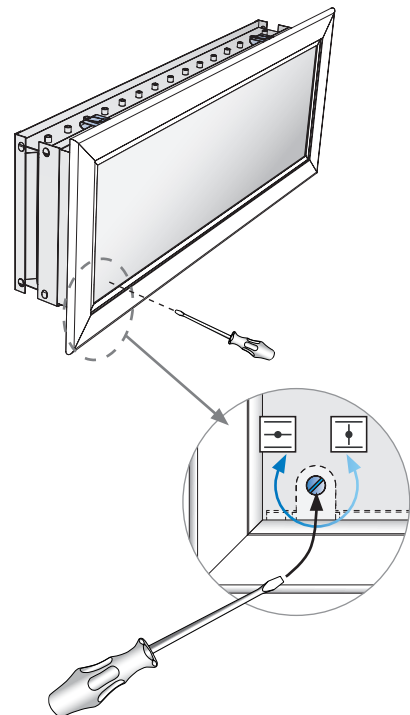

# AD, AR, AE, AC

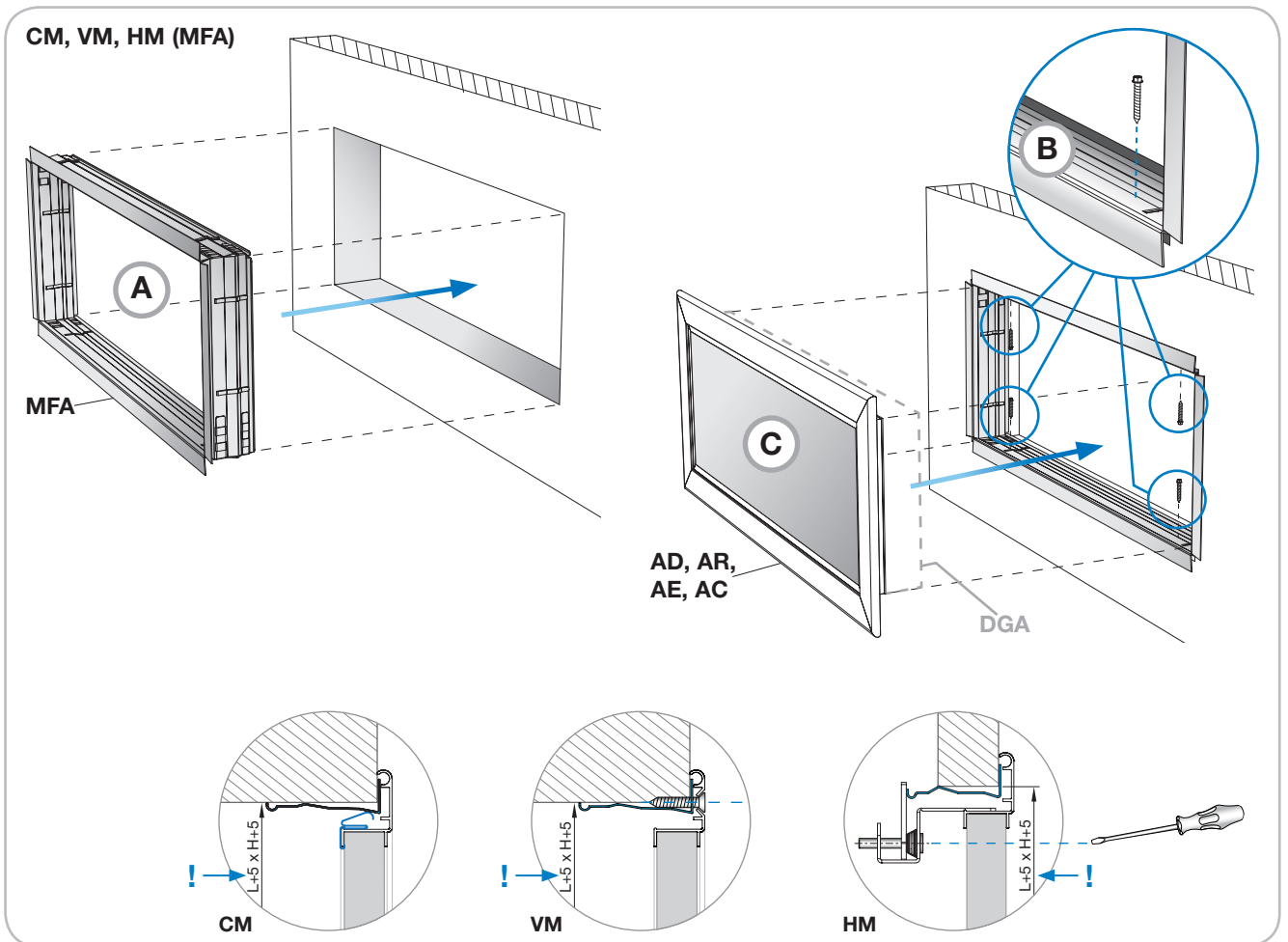
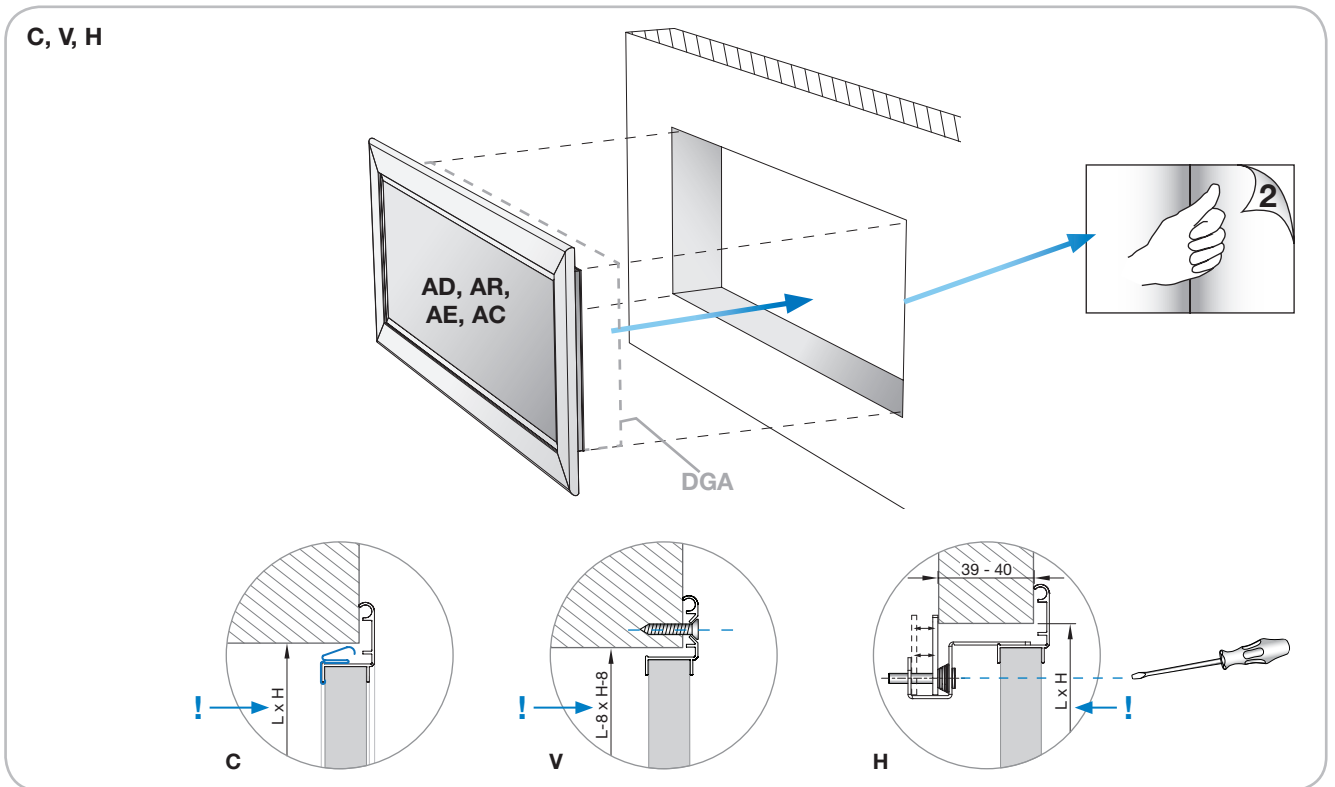

# AD, AR, AE, AC

Number of Visible screw holes  
 Antal synlige skruehuller  
 antal synliga skruvhål  
 Number of Visible screw holes -FIN  
 Anzahl sichtbare Schraubenlöcher  
 Numero di fori visibili  
 Nombre de trous pour vis visibles

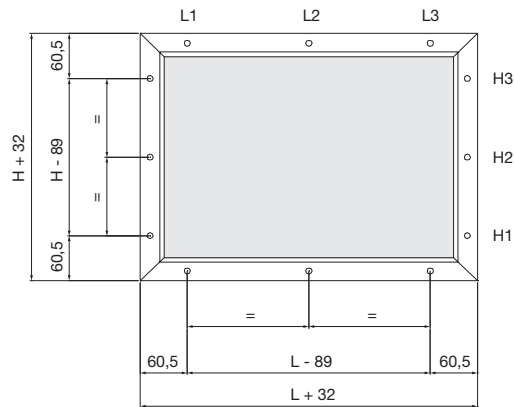
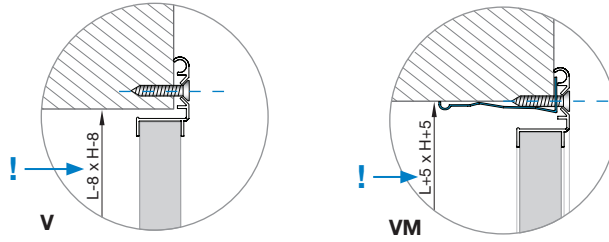

## AD, AR, AE, AC (L x H)

Nominal dimensions / Nominelle dimensioner / Nominelle dimensioner / Nimelliskoko /  
 Nominelle Dimensionen / Dimensioni nominali / Dimensions nominales

### L ≤ 400 mm

L mm	L			H mm	H		
	L1	L2	L3		H1	H2	H3
100 - 400 *	●	●	●	75 - 300 **		●	
				400 - 700	●		●
				800 - 1400 ***	●	●	●

\* AC: Min. L = 200 mm

\*\* AC-11 / AC-13 : Min. H = 100 mm  
 AC-12 / AC-14 : Min. H = 150 mm

\*\*\* AR, AE, AC : Max. H = 1200 mm

### L > 400 mm

L mm	L			H mm	H		
	L1	L2	L3		H1	H2	H3
500 - 700	●	●	●	75 - 500 **			
800 - 1500 *	●	●	●	600 - 900		●	
				1000 - 1500 ***	●	●	●

\* AR, AE, AC: Max. L = 1200 mm  
 AD : Max. L = 1500 mm

\*\* AC-11 / AC-13 : Min. H = 100 mm  
 AC-12 / AC-14 : Min. H = 150 mm

\*\*\* AR, AE, AC : Max. H = 1200 mm

# AD, AR, AE, AC

**Fixed blades**  
**Faste lameller**  
**Fasta lameller**  
**Kiinteät säleät**  
**Feststehenden Lamellen**  
**Alette fisse**  
**Lamelles fixes**

**AR-11**



**AE-11**

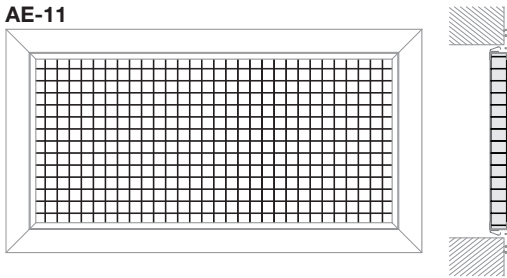

**AE-12**

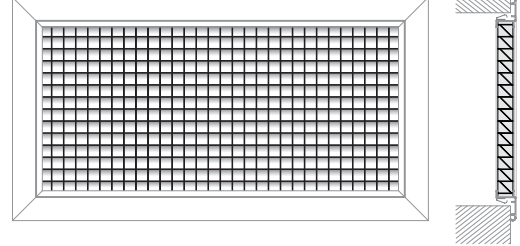

# AD, AR, AE, AC

Adjustable blades  
 Justerbare lameller  
 Ställbara lameller  
 Säädettävät säleet  
 Einstellbaren Lamellen  
 Alette regolabili  
 Ailettes réglables

AC-11

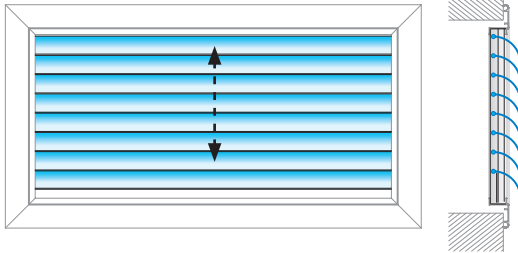

AC-12

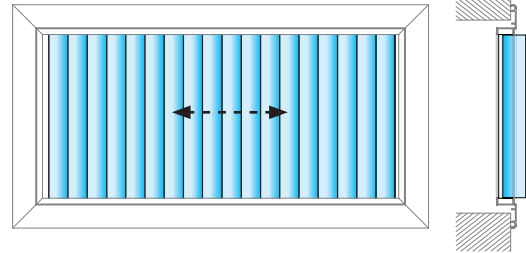

AC-13

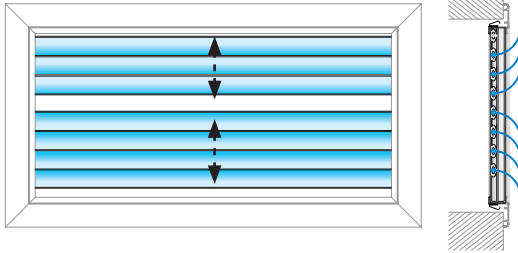

AC-14

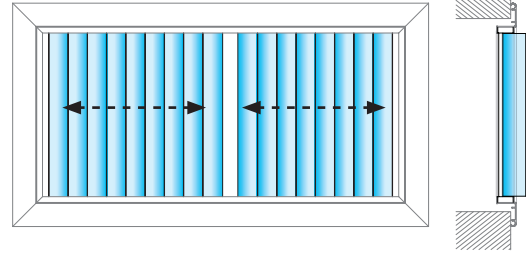

AD-11

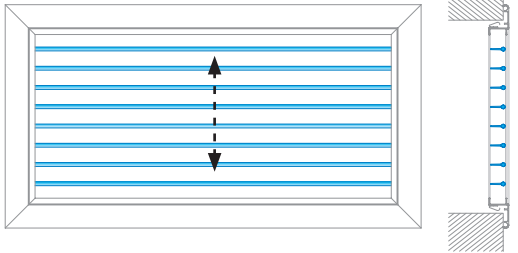

AD-12

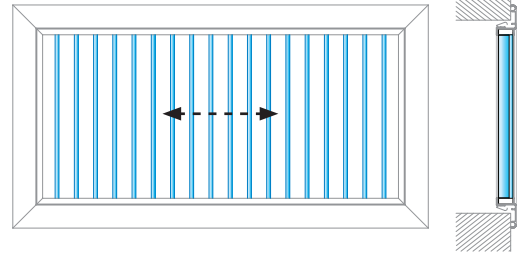

AD-21

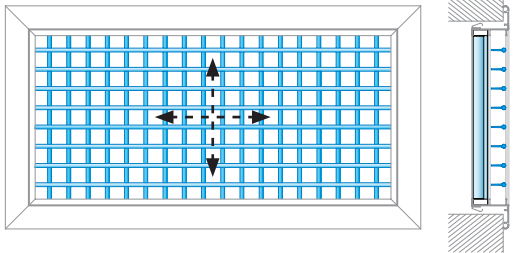

AD-22

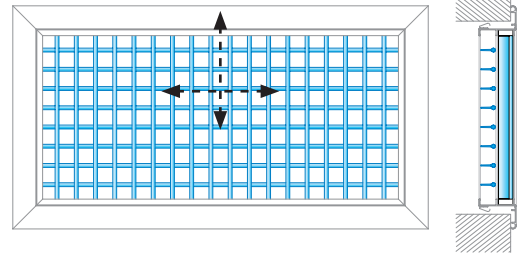



## Good Thinking

**At Lindab**, good thinking is a philosophy that guides us in everything we do. We have made it our mission to create a healthy indoor climate - and to simplify the construction of sustainable buildings. We do that by designing innovative products and solutions that are easy to use, as well as offering efficient availability and logistics. We are also working on ways to reduce our impact on our environment and climate. We do that by developing methods to produce our solutions using a minimum of energy and natural resources, and by reducing negative effects on the environment. We use steel in our products. It's one of few materials that can be recycled an infinite number of times without losing any of its properties. That means less carbon emissions in nature and less energy wasted.

**We simplify construction**