

Boxed Centrifugal Fan

BCF FIRE



Description

Backward curved centrifugal impeller in soundproof cabinet 400°C/2H within the hazardous area.

Box manufactured in galvanised steel sheet. Soundproof cabinets with grey M1 fire resistance insulated panels. Circular inlet flange.

Backward curved impeller, direct drive motor. Standard asynchronous squirrel-cage motor with IP-55 protection and Class H insulation type F400 2h.

Manufactured with standard voltages: 230/400V 50Hz in three phase motors up to 3kW, and 400/690V 50Hz for higher powers.

Official homologation by the European laboratory APPLUS according to EN 12101-3:2002, EN 12101-3:2002/AC:2005

Dimensions

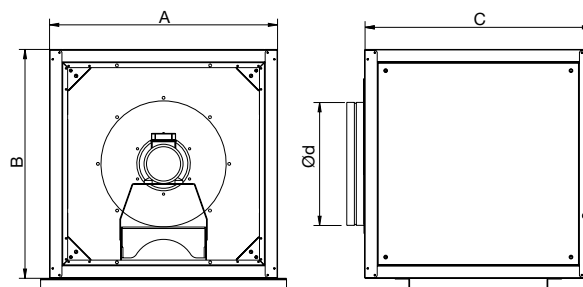

Product	Ød mm	A mm	B mm	C mm	m kg
BCF FIRE 400 T6 0,55KW	400	800	800	800	115
BCF FIRE 400 T4 0,75KW	400	800	800	800	115
BCF FIRE 450 T6 0,55KW	450	800	800	800	141
BCF FIRE 450 T4 1,1KW	450	800	800	800	142
BCF FIRE 500 T6 0,55KW	500	925	925	925	146
BCF FIRE 500 T4 1,5KW	500	925	925	925	147
BCF FIRE 560 T6 0,75KW	560	925	925	925	176
BCF FIRE 560 T4 2,2KW	560	925	925	925	187
BCF FIRE 630 T4 5,5KW	630	1000	1000	1000	198
BCF FIRE 630 T6 1,5KW	630	1000	1000	1000	218
BCF FIRE 710 T4 7,5KW	710	1000	1000	1000	263
BCF FIRE 710 T6 2,2KW	710	1000	1000	1000	273
BCF FIRE 800 T6 4KW	800	1060	1060	1060	339
BCF FIRE 800 T4 15KW	800	1060	1060	1060	339

T= 400 volt
M = 230 volt

Ordering example

	BCF FIRE	560	T	6	0,75 kW
Product					
Size					
Voltage					
Polarity					
Motor					

Boxed Centrifugal Fan

BCF FIRE

Technical data

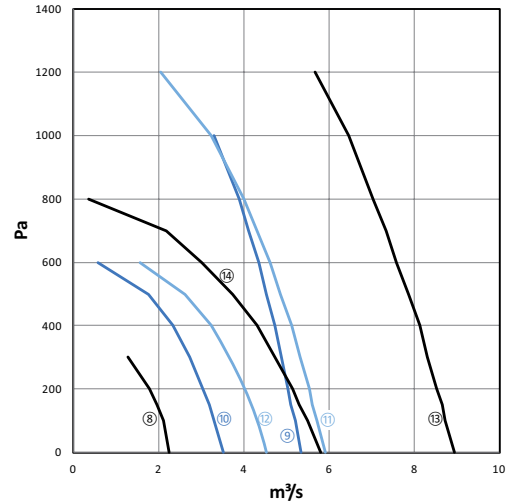
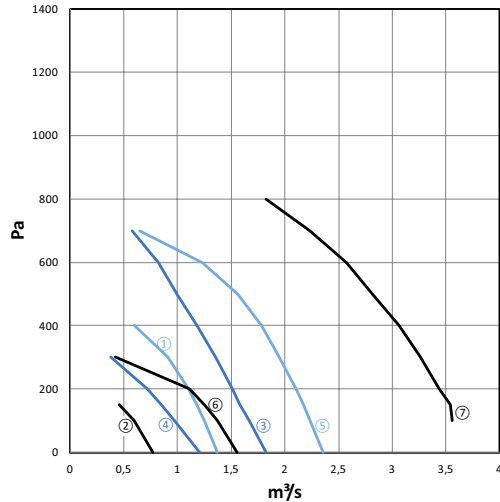

Graph Ref.	Product	m ³ /s @ Pa												Motor W	Amps FLC	Speed RPM
		0	100	150	200	300	400	500	600	700	800	1000	1200			
1	BCF FIRE 400 T4 0,75KW	1,37	1,25	1,18	1,1	0,91	0,6							750	2,84	1430
2	BCF FIRE 400 T6 0,55KW	0,77	0,6	0,46										550	2,93	940
3	BCF FIRE 450 T4 1,1KW	1,82	1,67	1,58	1,51	1,35	1,18	1	0,82	0,58				1100	4,67	1430
4	BCF FIRE 450 T6 0,55KW	1,21	0,97	0,85	0,72	0,38								550	2,93	950
5	BCF FIRE 500 T4 1,5KW	2,36	2,23	2,17	2,1	1,95	1,78	1,56	1,23	0,65				1500	6,07	1440
6	BCF FIRE 500 T6 0,55KW	1,55	1,37	1,25	1,11	0,42								550	2,93	950
7	BCF FIRE 560 T4 2,2KW		3,56	3,54	3,44	3,26	3,04	2,82	2,57	2,23	1,82			2200	7,87	1455
8	BCF FIRE 560 T6 0,75KW	2,25	2,12	1,96	1,79	1,29								750	3,77	920
9	BCF FIRE 630 T4 5,5KW	5,33	5,2	5,1	5,04	4,87	4,72	4,52	4,35	4,11	3,89	3,3		5500	10,58	1455
10	BCF FIRE 630 T6 1,5KW	3,52	3,29	3,18	3,04	2,73	2,34	1,77	0,58					1500	6,24	930
11	BCF FIRE 710 T4 7,5KW	5,92	5,72	5,6	5,53	5,32	5,12	4,86	4,61	4,32	4,01	3,23	2,06	7500	14,46	1450
12	BCF FIRE 710 T6 2,2KW	4,52	4,32	4,17	4,03	3,65	3,23	2,63	1,56					2200	9,05	960
13	BCF FIRE 800 T4 15KW	8,93	8,71	8,65	8,53	8,31	8,13	7,86	7,58	7,33	7,04	6,46	5,68	15000	27,9	1455
14	BCF FIRE 80 T6 4KW	5,81	5,49	5,3	5,14	4,72	4,3	3,74	3,008	2,18	0,37			4000	8,97	945

Graph Ref.	Product	Sound Power Level (Breakout)								dB(A) @ 3m
		63	125	250	500	1K	2K	4K	8K	
1	BCF FIRE 400 T4 0,75KW	47	61	67	70	70	71	61	50	56
2	BCF FIRE 400 T6 0,55KW	37	51	57	60	60	61	51	40	46
3	BCF FIRE 450 T4 1,1KW	57	67	72	74	76	76	67	59	60
4	BCF FIRE 450 T6 0,55KW	47	57	62	64	66	66	57	49	50
5	BCF FIRE 500 T4 1,5KW	66	72	77	78	81	80	73	68	65
6	BCF FIRE 500 T6 0,55KW	56	62	67	68	71	70	63	58	55
7	BCF FIRE 560 T4 2,2KW	67	73	79	79	83	83	75	68	67
8	BCF FIRE 560 T6 0,75KW	57	63	69	69	73	73	65	58	57
9	BCF FIRE 630 T4 5,5KW	74	79	85	87	85	82	75	67	71
10	BCF FIRE 630 T6 1,5KW	63	65	66	75	78	66	59	58	60
11	BCF FIRE 710 T4 7,5KW	80	81	89	92	95	96	92	78	80
12	BCF FIRE 710 T6 2,2KW	65	67	68	73	76	62	58	51	58
13	BCF FIRE 800 T4 15KW	88	94	99	100	104	103	96	89	88
14	BCF FIRE 80 T6 4KW	64	68	69	74	69	64	60	54	60