

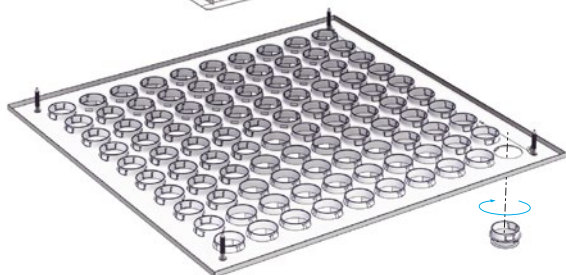

# VERSIO-V

Mounting instruction  
Installations vejledning  
Montageanvisning  
Asennusohje  
Montageanweisung  
Istruzioni di montaggio  
Инструкция по монтажу  
Instructions de montage

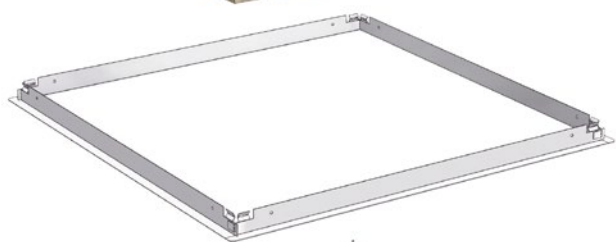



# Versio-V

## Contents

### Indhold

### Innehållsförteckning

### Sisällysluettelo

### Inhalt

### Sommario

### Содержание

### Sommaire

No Damper - Ingen Spjæld - Utan spjäll - Ei Säätöpelti - Keine Drossel - Nessuno Serranda - Без Регулятор - Pas de registre.....	3
No Measuring outlet - Ingen måleudtag - Utan mätuttag - Ei mittausyhteellä - Keine Meßstutzen - Senza punti per misura pressione - Без измерительного устройства - Pas de prise de pression.....	3
Frame - Ramme - Ram - Kehys - Rahmen - Telaio - Рамка - Cadre.....	3
Faceplate and service wires - Bundplade og service wirer - Bottenplatta och service vajer - Faceplate and huoltovaijerit -FIN Frontplate und Service Drähte - Frontale e avi per manutenzione - Faceplate and Сервисный трос RUS - Façade et Câble de maintien.....	5
Accessories MBB - Tilbehør MBB - Tilbehör MBB - Lisävarusteet MBB Zubehör MBB - Accessori MBB - Аксессуары MBB - Accessoires MBB.....	7
Versio-V PS1-4.....	11
Versio-V PS8-11.....	13
Versio-V RS14.....	15
Versio-V RS15-16.....	17
Versio-V NS19.....	20
Versio-V GS23.....	23

## Maintenance

### Vedligeholdelse

### Underhåll

### Huolto

### Wartung

### Manutenzione

### Обслуживание

### Entretien

<b>UK</b>	- The diffuser can be demounted and vacuum cleaned by using a smooth nozzle brush or wiped off by using a sponge or a damp soft cotton cloth
<b>DK</b>	- Diffusoren kan demonteres og støvsuges med et blødt børstestykke eller aftørres med en fugtig klud.
<b>SE</b>	- Donet kan demonteras och dammsugas med ett mjukt borstmunstycke eller torkas av med en fuktig trasa.
<b>FI</b>	- Laite voidaan puhdistaa imurilla käyttäen pehmeää harjaosaa tai se voidaan pyyhkiä kostutetulla kangasliinalla.
<b>DE</b>	- Der Durchlass kann zur Reinigung demontiert werden. Die Reinigung erfolgt entweder mit einem Staubsauger mit einer weichen Düsenbürste oder mit einem weichen Baumwolltuch, das in klares Wasser getaucht und gut ausgewrungen wurde.
<b>IT</b>	- Il diffusore può essere pulito con una spazzola morbida oppure con una spugna o un panno di cotone leggermente umidi.
<b>RU</b>	- Диффузор можно чистить с помощью пылесоса с гладкой насадкой, вытирать губкой или влажной сильно отжатой хлопчатобумажной тканью.
<b>FR</b>	- Le diffuseur peut être démonté et nettoyé avec une brosse d'aspirateur, une éponge propre ou un chiffon humide doux en coton.



# Versio-V

No Damper  
 Ingen Spjæld  
 Utan spjäll  
 Ei Säätopelti  
 Keine Drossel  
 Senza Serranda  
 Без Регулятора  
 Pas de registre

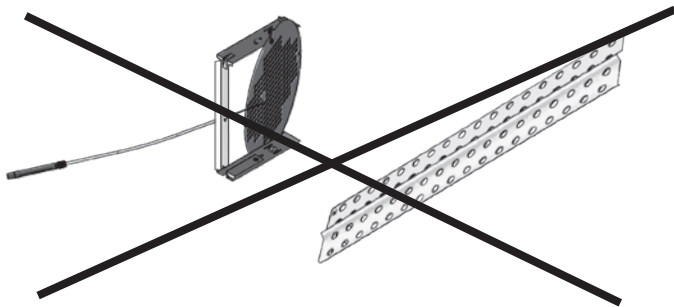

No Measuring outlet  
 Ingen Måleudtag  
 Utan mätutag  
 Ei mittausyhteellä  
 Keine Anschluß eines Meßgerätes  
 Senza punti per misura pressione  
 Без измерительного устройства  
 Pas de prise de pression

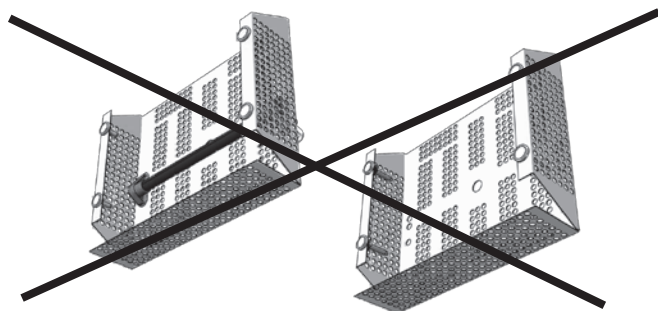

Frame  
 Ramme  
 Ram  
 Kehys  
 Rahmen  
 Telaio  
 Рамка  
 Cadre

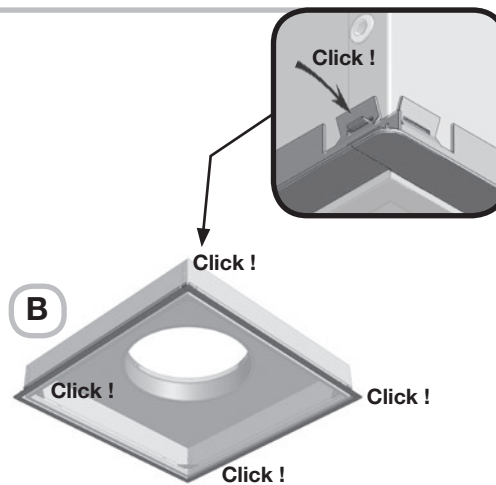
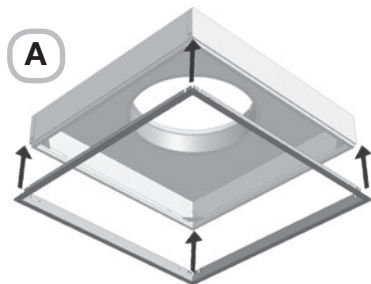

Demounting  
 Demontering  
 Demontering  
 Irrotus  
 Démontage  
 Smontaggio  
 Демонтаж  
 Démontage

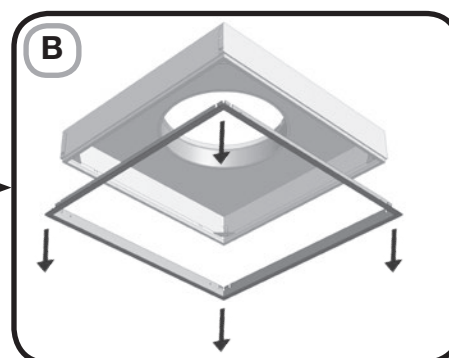
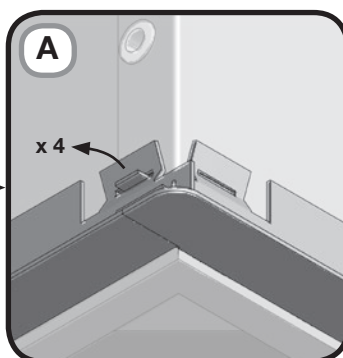



# Versio-V

**Frame or full faceplate**  
**Ramme eller fuld bundplade**  
**Ram eller hel bottenplatta**  
**Kehystä or Täysi hajottajaosa**  
**Rahmen oder Frontplatte ohne Rahmen**  
**Telaio or Frontale senza telaio**  
**Рамка or Лицевая часть без рамки**  
**Cadre ou façade pleine**

Example:  
 Eksempel:  
 Exempel:  
 Esimerkki:  
 Beispiel:  
 Esempio:  
 Пример:  
 Exemple:

NS19



Frame - Ramme  
 Ram  
 Kehys  
 Rahmen  
 Telaio  
 Рамка  
 Cadre



Full face plate - Fuld bundplade  
 Hel bottenplatta  
 Täysi hajottajaosa  
 Frontale senza telaio  
 Frontplatte ohne Rahmen  
 Лицевая часть без рамки  
 Façade pleine



Ceiling type no. Lofttype nr. Undertaks typ nr. Alakaton tyyppi nro. Deckentyp Nr. Tipo di soffitto n. Тип потолка № Type plafond n°	Pattern - Mønster - Mönster - Malli - Muster - Modello - Модель - Taille								
	600		500		400		300		
1, 21, 3	✓	÷	✓	÷	✓	÷	✓	÷	÷
7, 8, 9, 10, 11, 14	÷	✓	✓	÷	✓	÷	✓	÷	÷

Ceiling type no. Lofttype nr. Undertaks typ nr. Alakaton tyyppi nro. Deckentyp Nr. Tipo di soffitto n. Тип потолка № Type plafond n°	Pattern - Mønster - Mönster - Malli - Muster - Modello - Модель - Taille								
	600		500		400		300		
2, 22	÷	✓	÷	✓	÷	✓	÷	✓	✓
4, 5, 6	÷	✓	÷	✓	÷	✓	÷	✓	✓

**Important**  
**Viktigt**  
**Viktigt**  
**Tärkeä**  
**Wichtig**  
**Importante**  
**Важно**  
**Important**



**UK** - The choice of frame or full faceplate with no frame, depends on which ceiling system and air pattern that are chosen. Go to chapter "Versio Ceiling systems" for detailed explanation.

**DK** - Valg af ramme eller fuld bundplade uden ramme, afhænger af hvilket loftsystem og mønster man vælger. Se afsnittet "Versio Loftsystemer" for detaljeret beskrivelse.

**SE** - Valet utav ram eller hel bottenplatta utan ram beror på vilken typ av undertakssystem och mönsterstorlek som är vald. Läs under kapitlet "Versio Undertakssystem" för detaljerad förklaring.

**FI** - Valinta kehyksen tai yhtenäisen hajottajan välillä riippuu kattojärjestelmästä ja siitä, mikä virtauskuviota valitaan. Lisätietoja löytyy "Versio Kattojärjestelmät" -asennusohjeesta.

**DE** - Ob die Frontplatte aus einem Stück oder mit einem Rahmen ist, hängt vom gewünschten Deckensystem und Muster ab. Gehen Sie zu Kapitel "Versio Deckensysteme" für detaillierte Erklärung.

**IT** - La scelta di utilizzare una piastra munita di cornice o meno dipende dal tipo di controsoffitto e di pattern di diffusione scelti. Per ulteriori informazioni fare riferimento al capitolo "Versio Sistemi di controsoffitto"

**RU** - Выбор рамки и лицевой части зависит от типа потолочной системы. Полная информация в каталоге в разделе Versio Адаптация к потолочной системе

**FR** - Le choix de cadre ou façade sans cadre dépend du système de plafond et du type de diffusion choisis. Voir le chapitre "Systèmes de plafond Versio" pour les explications détaillées.



# Versio-V

Faceplate  
 Bundplade  
 Bottenplatta  
 Faceplate -FIN  
 Frontplatte  
 Frontale  
 Faceplate -RUS  
 Façade

Service wires  
 Service wirer  
 Service vajer  
 Huoltovaijerit  
 Service Drähte  
 Cavi per manutenzione  
 Сервисный трос  
 Câbles de maintien

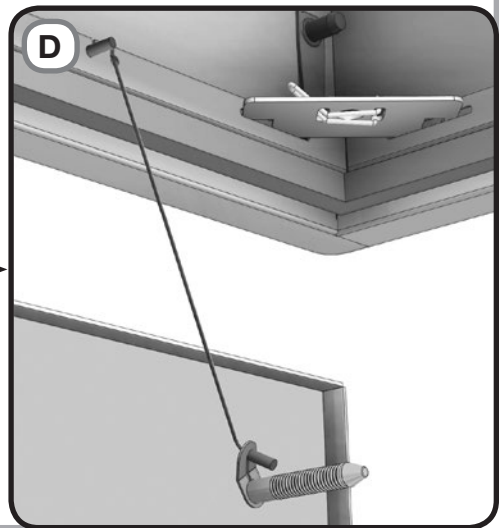
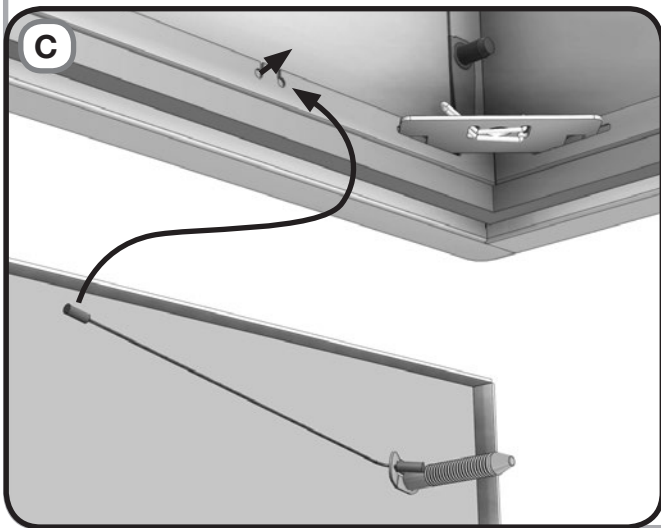
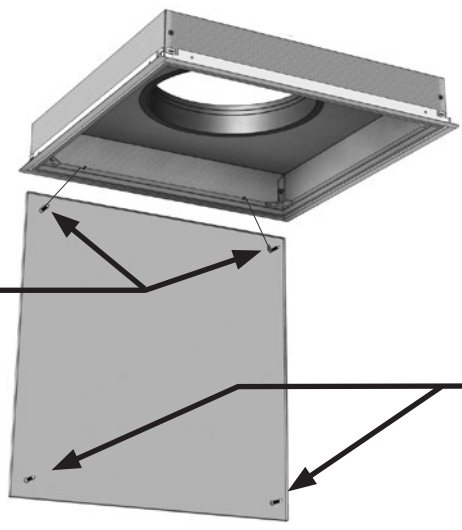
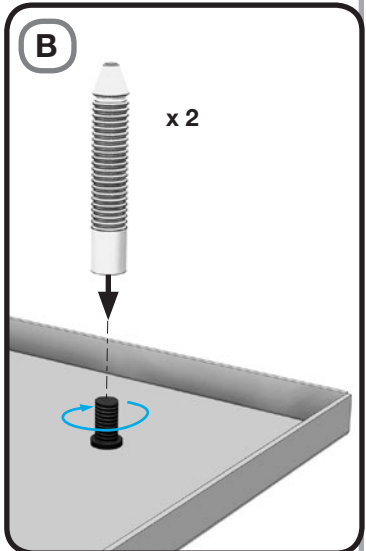
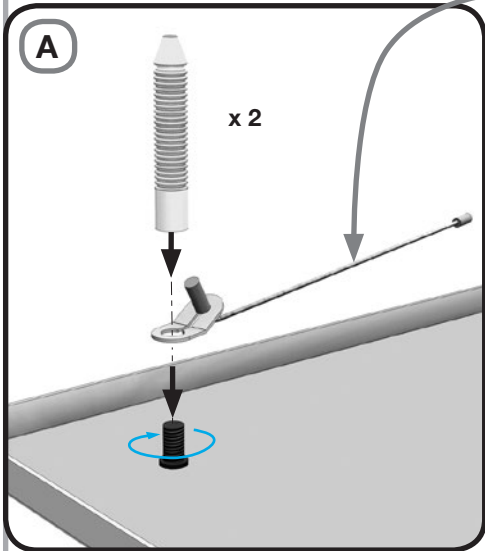



# Versio-V

Faceplate  
 Bundplade  
 Bottenplatta  
 Faceplate -FIN  
 Frontplatte  
 Frontale  
 Faceplate -RUS  
 Façade

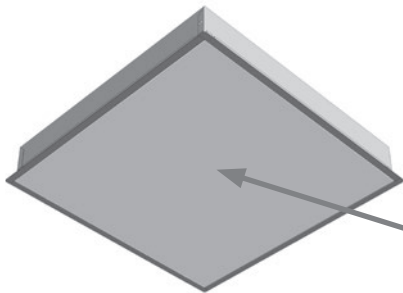
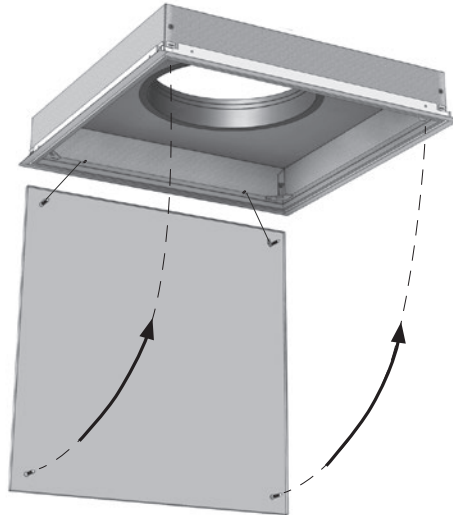

Adjustable  
 Justerbar  
 Justerbar  
 Adjustable -FIN  
 Einstellbar  
 Regolabili  
 Adjustable -RUS  
 Réglables

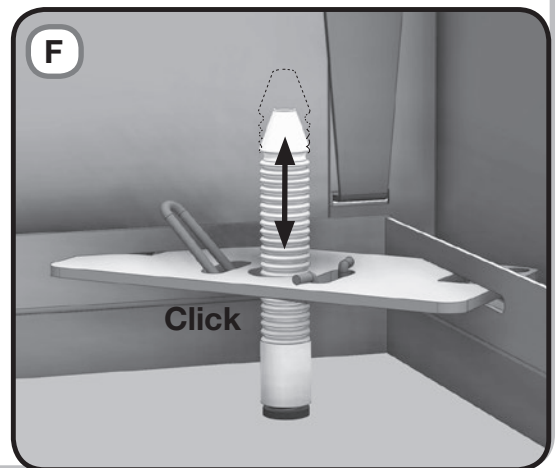
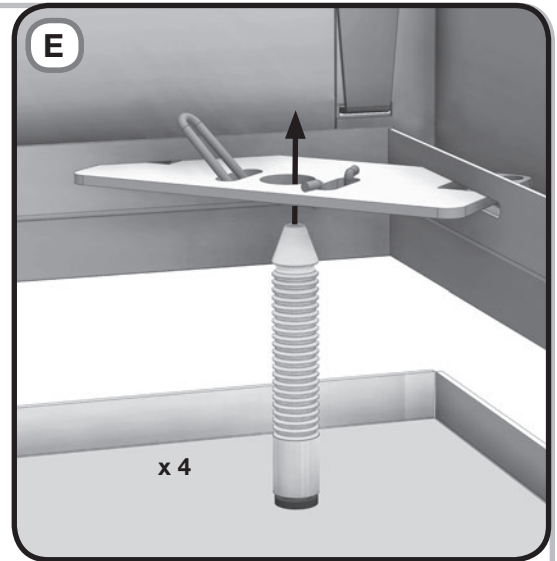

Demounting  
 Demonerung  
 Demonerung  
 Irrotus  
 Demontage  
 Smontaggio  
 Демонтаж  
 Démontage

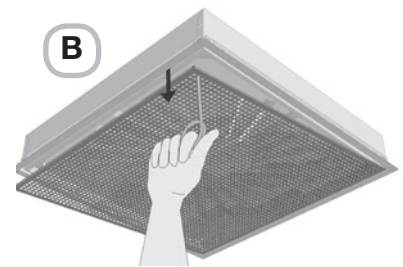
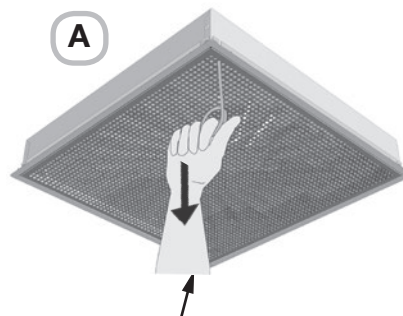

Lindab tool - Not included  
 Lindab verktøj - ikke inkluderet  
 Lindab verktyg - Ej inkluderat  
 Lindab työkalu - ei laitetoimituksessa  
 Lindab Werkzeug - Nicht enthalten  
 Attrezzo Lindab - Non incluso  
 Lindab инструмент - Не включенно  
 Outil Lindab - Non fourni

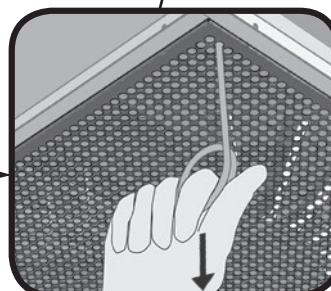



# Versio-V

# MBB

Accessories-MBB    Tilbehør-MBB    Tillbehör-MBB    Lisävarusteet-MBB    Zubehör-MBB    Accessori-MBB    Аксессуары-MBB    Accessoires-MBB

**Accessories / Plenum box MBB**  
**Tilbehør / Trykfordelingsboks MBB**  
**Tillbehör / Tryckfördelningslåda MBB**  
**Lisävarusteet / Liitäntälaatikko MBB**  
**Zubehör / Anschlusskasten MBB**  
**Accessori / Plenum MBB**  
**Аксессуары / Расширительные камеры MBB**  
**Accessoires - Plénum MBB**

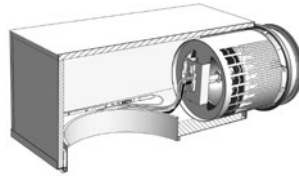

**MBB**

**Damper**  
**Spjæld**  
**Spjäll**  
**Säätöpelti**  
**Drossel**  
**Serranda**  
**Регулятор**  
**Registre**

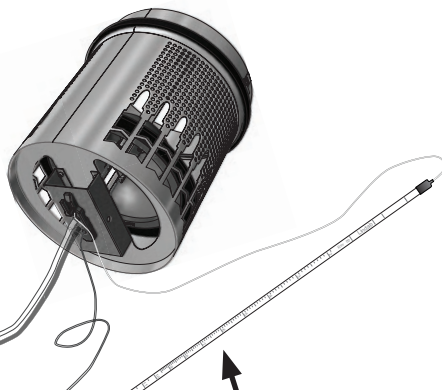

Measuring outlets  
 Måleudtag  
 Mätuttag  
 Mittausyhteet  
 Für den Anschluß eines  
 Meßgerätes  
 Punti per misura pressione  
 Измерительные  
 патрубки  
 Prises de pression

Read the k-factor scale  
 Aflæs af k-faktor skalaen  
 Avläs k-faktorn  
 Lue k-arvo asteikolta  
 k-Wert ablesen.  
 Lettura della scala  
 graduate del fattore k  
 Определение значения  
 К-фактор  
 Lire la règlette coefficient k

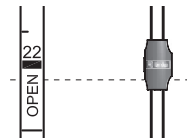

**Dimensions**  
**Dimensioner**  
**Dimensioner**  
**Mitat**  
**Dimensionen**  
**Dimensioni**  
**Размеры**  
**Dimensions**

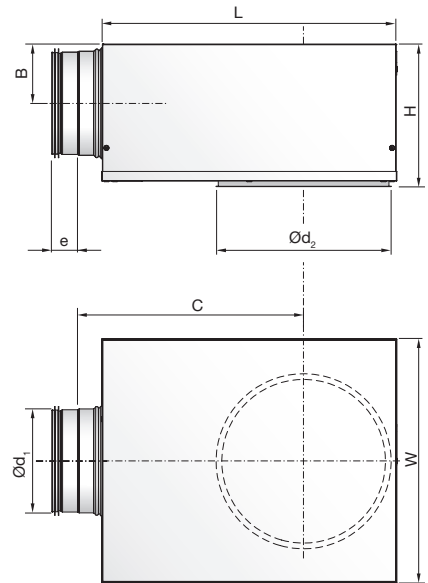

Ød <sub>1</sub> mm	Ød <sub>2</sub> mm	W mm	H mm	B mm	C mm	e mm	L mm	m kg
100	100	260	163	62	245	40	310	2,6
100	125	260	163	62	245	40	310	2,6
100	160	260	163	62	245	40	310	2,6
125	125	310	188	75	291	40	376	3,7
125	160	310	188	75	291	40	376	3,7
125	200	310	188	75	291	40	376	3,7
160	160	380	222	92	352	40	459	5,5
160	200	380	222	92	352	40	459	5,5
160	250	380	222	92	352	40	459	5,5
200	200	460	263	112	425	40	565	7,3
200	250	460	263	112	425	40	565	7,3
200	315	460	263	112	425	40	565	7,3
250	250	540	313	137	514	60	698	10,6
250	315	540	313	137	514	60	698	10,6
250	400	540	313	137	514	60	698	10,6
315	315	540	378	170	675	60	858	13,5
315	400	540	378	170	675	60	858	13,5

**Order code**  
**Ordre kode**  
**Beställningskod**  
**Tuotekoodi**  
**Bestellcode**  
**Codice d'ordine**  
**Код Заказа**  
**Codification**

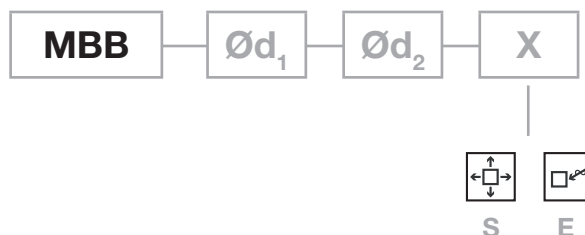



# Versio-V

# MBB

Accessories-MBB    Tilbehør-MBB    Tillbehör-MBB    Lisävarusteet-MBB    Zubehör-MBB    Accessori-MBB    Аксессуары-MBB    Accessoires-MBB

- Mounting of MBB - MHS
- Ophængning af MBB - MHS
- Upphängning av MBB - MHS
- Kannakointi MBB - MHS
- Montage des MBB - MHS
- Montaggio di MBB - MHS
- Монтаж MBB - MHS
- Montage de MBB - MHS

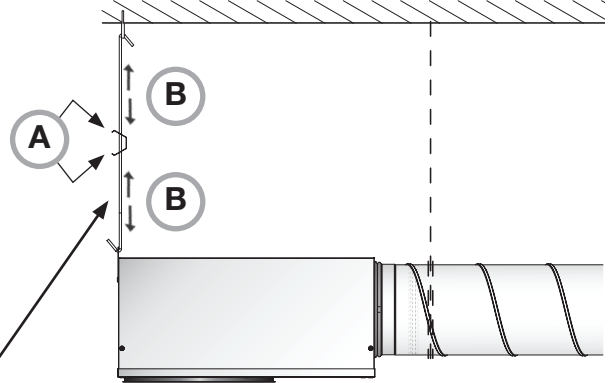
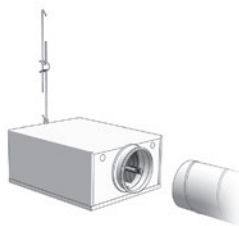

## MHS

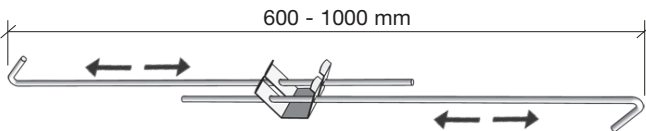

- Threaded bar
- Gevindstang
- Gängstång
- Kierretanko
- Gewindestange
- Barre filettate
- Крепежная шпилька
- Tiges filetées

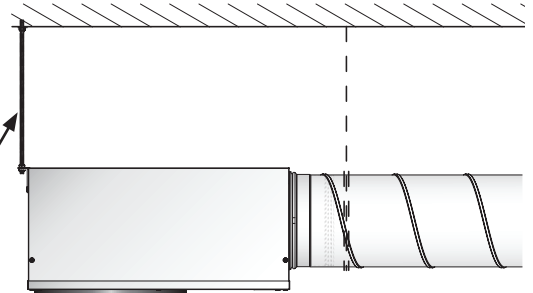
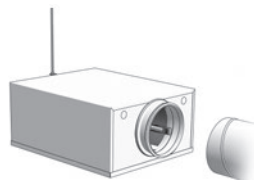

## M6



- Directly against ceiling
- Direkte mod loft
- Dikt mot tak
- Suoraan kattopintaan
- Direkt an die Decke
- Direttamente a soffitto
- к потолку
- Directement contre le plafond

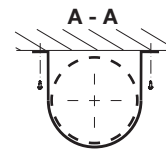
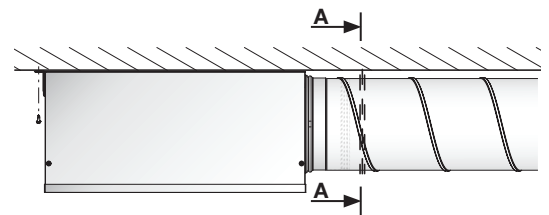
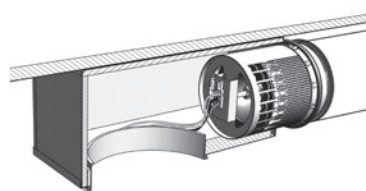

- Mounting of MBB, details go to - Mounting -and balancing instruction
- Ophængning af MBB, detaljer se - Montage -og indregulerings vejledning
- Upphängning av MBB, Detaljer gå till - Montage och injusteringsinstruktion
- Kannakointi MBB, details go to - Asennus- ja säätöohjeet
- Montage des MBB, details go to - Montage und Einregulierungsanweisung
- Montaggio di MBB, details go to - Istruzioni di montaggio e bilanciamento
- Монтаж MBB, details go to - Инструкция по монтажу и балансировке
- Montage de MBB, détails voir - Instructions de montage et réglage

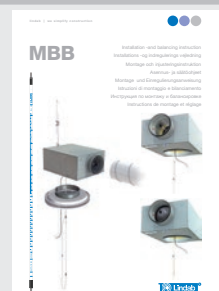





# Versio-V

# MBB

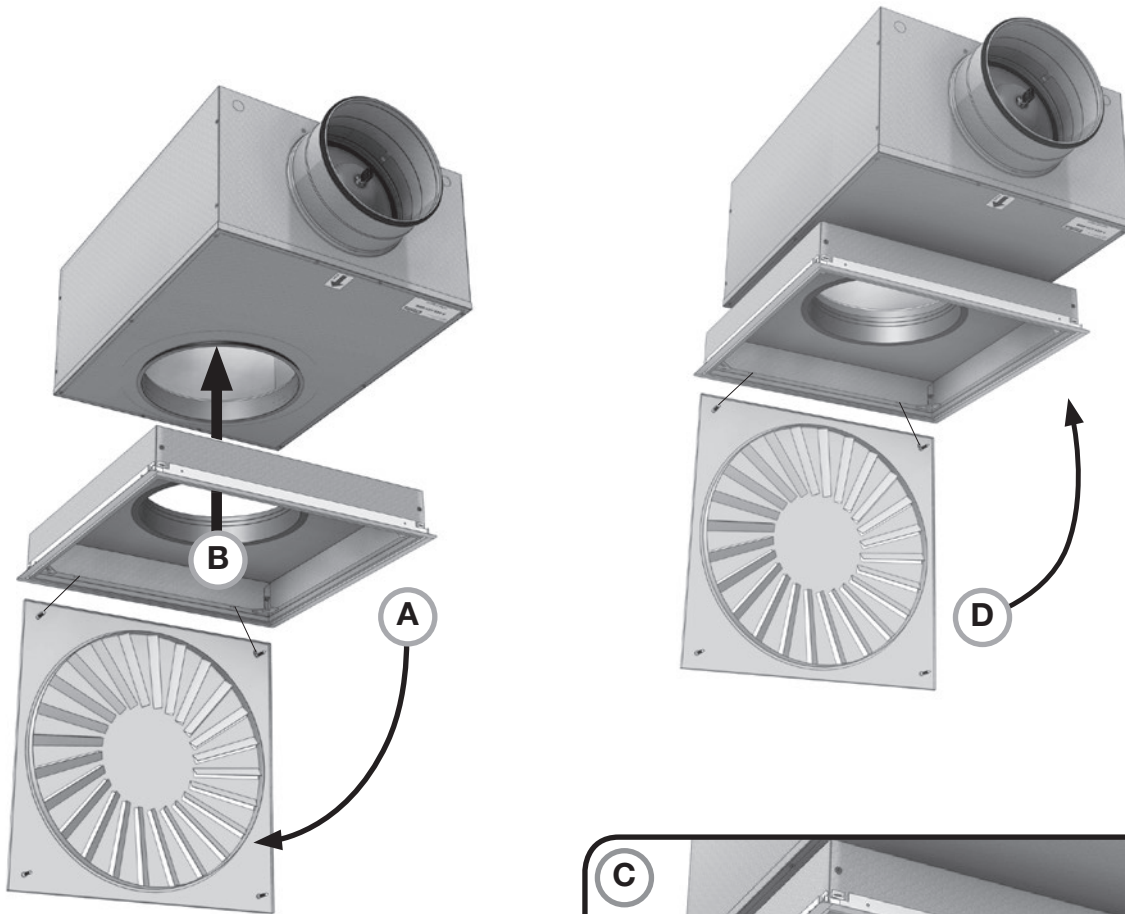

Accessories-MBB    Tilbehør-MBB    Tillbehör-MBB    Lisävarusteet-MBB    Zubehör-MBB    Accessori-MBB    Аксессуары-MBB    Accessoires-MBB

- Mounting of Versio-V + MBB
- Montering af Versio-V + MBB
- Montering av Versio-V + MBB
- Mounting of Versio-V + MBB - FIN
- Montage des Versio-V + MBB
- Montaggio di Versio-V + MBB
- Mounting of Versio-V + MBB - RUS
- Montage de Versio-V + MBB

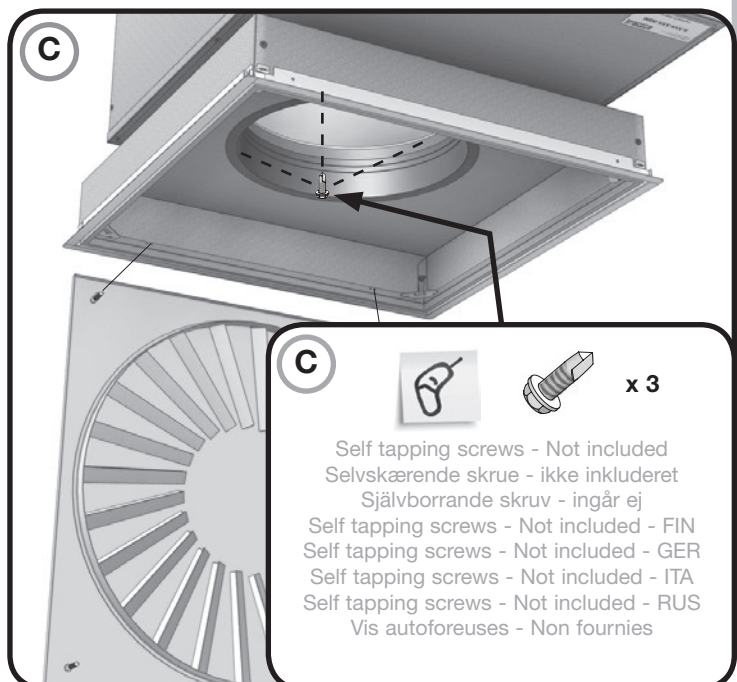
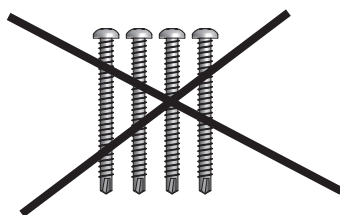

Mounting kit included in MBB - Not used  
 Monteringsæt medfølger i MBB - Anvendes ikke  
 Montagekit inkluderat i MBB - Används ej  
 Mounting kit included in MBB - Not used - FIN  
 Befestigungssatzes im MBB - Nicht verwendet - GER  
 Mounting kit included in MBB - Non utilizzati - ITA  
 Mounting kit included in MBB - Not used - RUS  
 Kit de montage livré avec MBB - Ne pas utiliser



**C**   x 3

Self tapping screws - Not included  
 Selvskærende skrue - ikke inkluderet  
 Självborrande skruv - ingår ej  
 Self tapping screws - Not included - FIN  
 Self tapping screws - Not included - GER  
 Self tapping screws - Not included - ITA  
 Self tapping screws - Not included - RUS  
 Vis autoforeuses - Non fournies



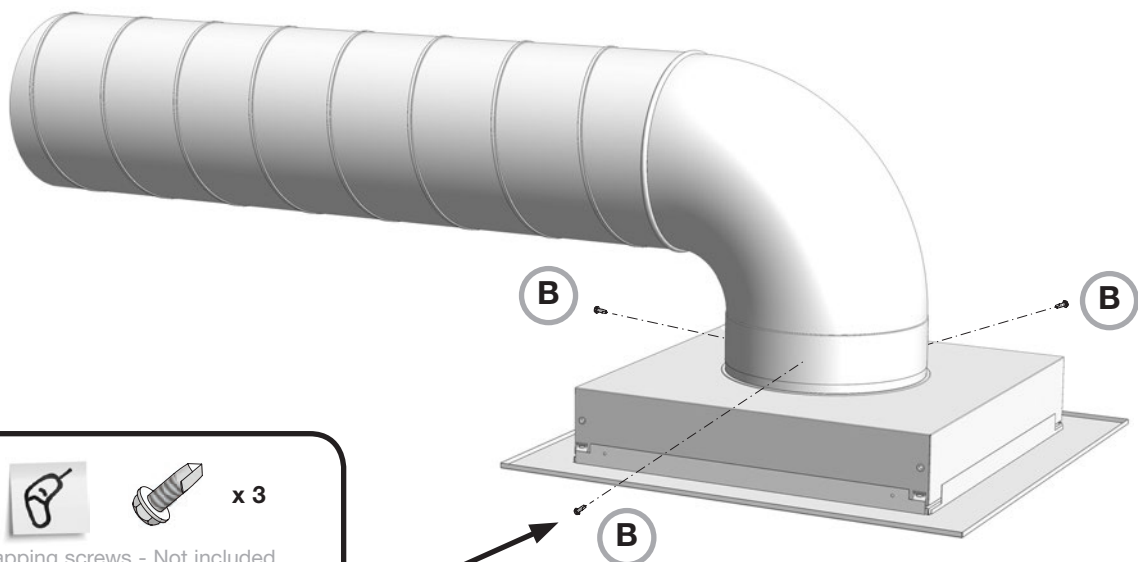
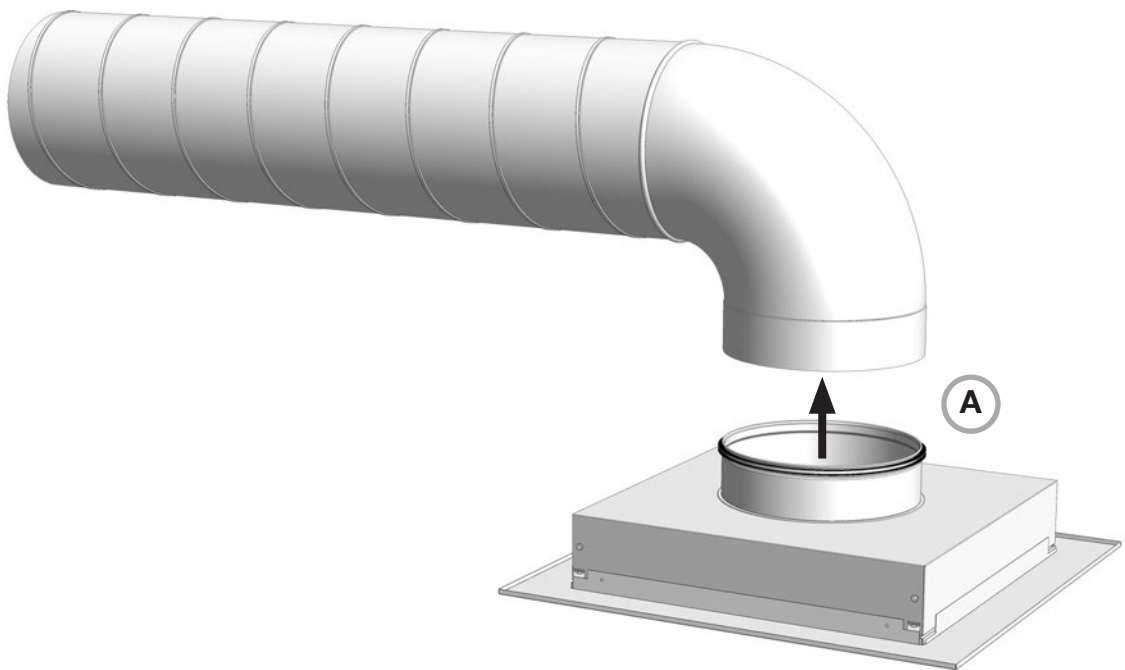

# Versio-V

**Mounting of Versio-V in duct**  
**Montering af Versio-V i kanal**  
**Montering av Versio-V i kanal**  
**Mounting of Versio-V in duct - FIN**  
**Montage des Versio-V in Rohr - DE**  
**Montaggio di Versio-V in duct -ITA**  
**Mounting of Versio-V in duct - RUS**  
**Montage de Versio-V sur conduit**



**B**

x 3

Self tapping screws - Not included  
 Selvskærende skrue - ikke inkluderet  
 Självborrande skruv - ingår ej  
 Self tapping screws - Not included - FIN  
 Self tapping screws - Not included - GER  
 Self tapping screws - Not included - ITA  
 Self tapping screws - Not included - RUS  
 Vis autoforeuses - Non fournies



# Versio-V

# PS1-V - PS4-V

Measure / weight  
 Mål / vægt  
 Mått / vikt  
 Mitta / paino  
 Abmessungen / Gewicht  
 Misure / peso  
 Размер / вес  
 Dimensions / Poids

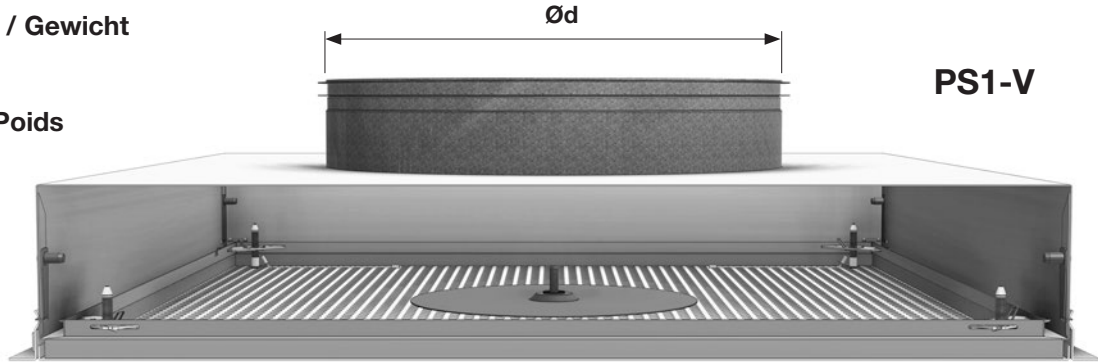

Ød mm	Pattern - Mønster - Mönster - Malli - Muster - Modello - модель - Taille	m kg
200	400	-
250	500	-
315	600	-

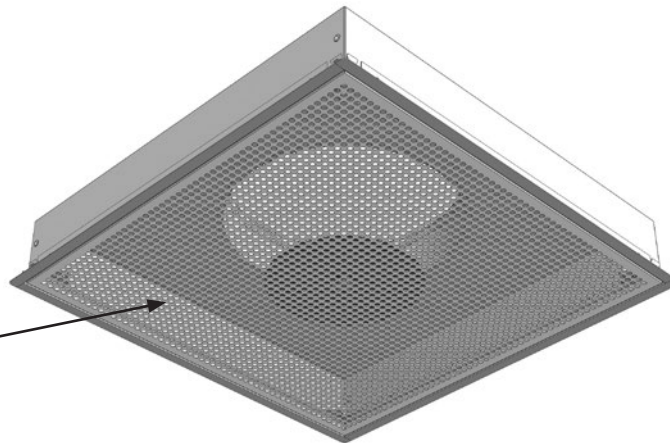

Pattern - See page 4  
 Mønster - Se side 4  
 Mönster - Se sida 4  
 Malli - See sivu 4  
 Muster - Siehe Seite 4  
 Modello - Vedi pagina 4  
 модель - See page 4  
 Taille - voir page 4

**Symbols**  
**Symboler**  
**Symboler**  
**Symbolit**  
**Symbole**  
**Simboli**  
**Обозначения**  
**Symbols**



No tools - magnet  
 Ingen værktøj - magnet  
 Inga verktyg - magnet  
 Ei työkaluja - Magneetit  
 Keine Werkzeuge - Magnet  
 Nessun attrezzi - magnete  
 Без инструмента - магнит  
 Sans outil - Aimants



Supply air  
 Indblæsning  
 Tilluft  
 Sisäänpuhallus  
 Zuluft  
 Aria di mandata  
 Приточная вентиляция  
 Soufflage



Exhaust air  
 Udsugning  
 Frånluft  
 Poistoilma  
 Abluft  
 Aria di estrazione  
 Вытяжная вентиляция  
 Extraction



Low impulse principle  
 Lavimpulsprincip  
 Lågimpulsprincip  
 Piennopeuspuhallus  
 Niedrigimpulslüftung  
 Ventilazione a basso impulso  
 Низкоскоростная вентиляция  
 Basse vitesse



# Versio-V

# PS1-V - PS4-V

Deflector plate  
 Afdækningsplade  
 Avskärmningsplåt  
 Deflector plate FIN  
 Deflector plate DE  
 Deflector plate ITA  
 Deflector plate RUS  
 Plaque déflectrice

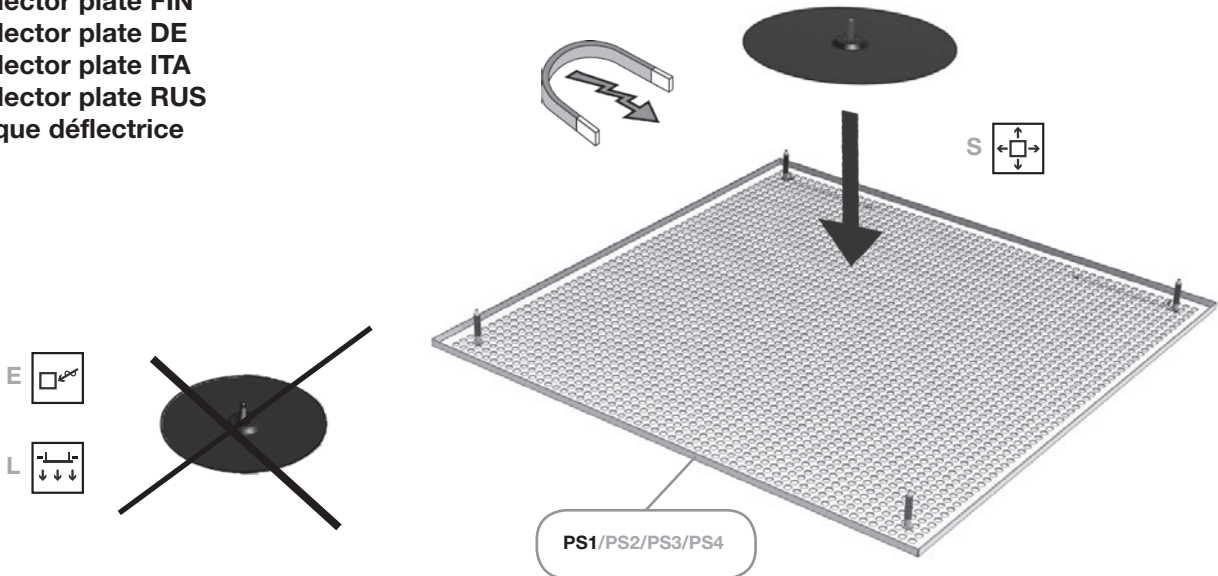

Order code  
 Bestillings kode  
 Beställningskod  
 Tilauskoodi  
 Bestellcode  
 Ordinazione  
 Код Заказа  
 Codification

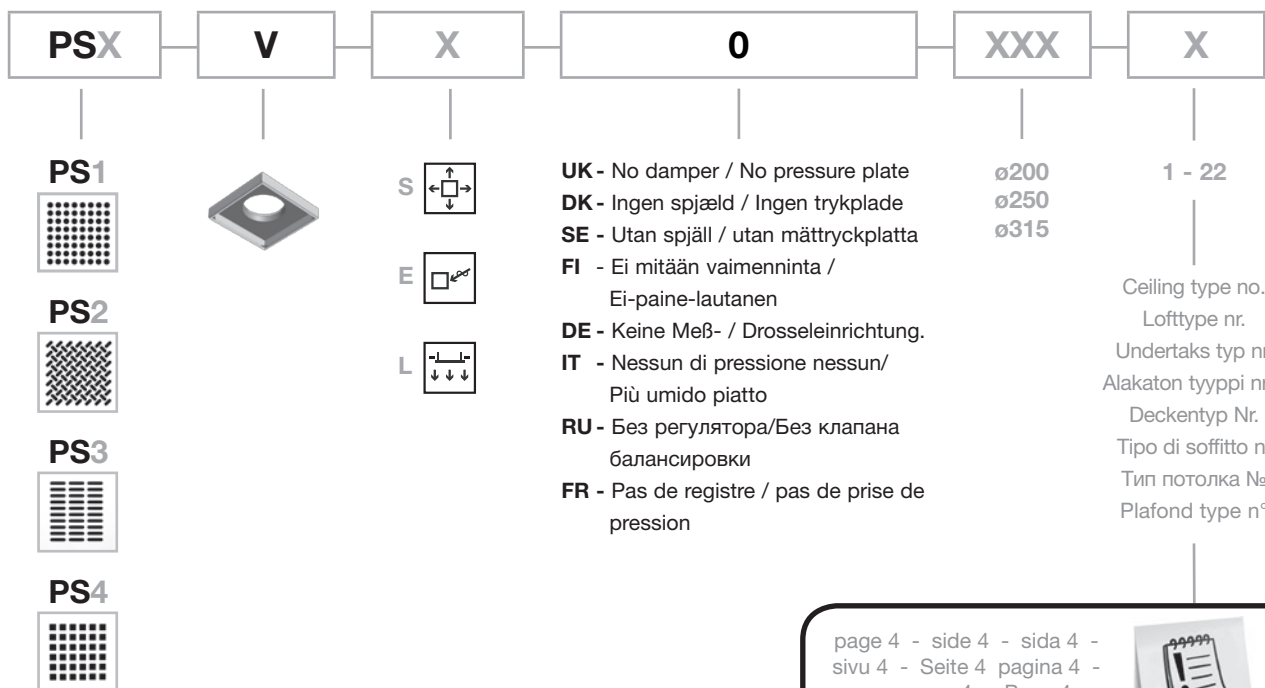

page 4 - side 4 - sida 4 -  
 sivu 4 - Seite 4 pagina 4 -  
 страница 4 - Page 4





# Versio-V

# PS8-V - PS11-V

Measure / weight  
 Mål / vægt  
 Mått / vikt  
 Mitta / paino  
 Abmessungen / Gewicht  
 Misure / peso  
 Размер / вес  
 Dimensions / Poids

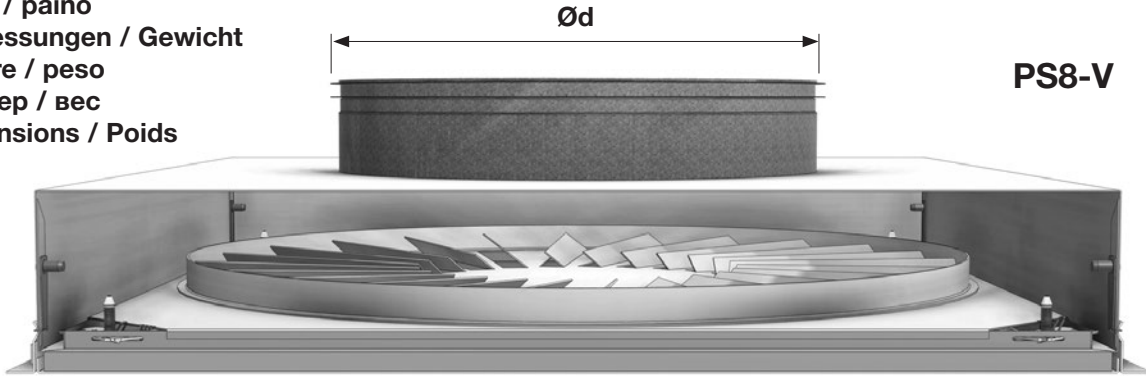

Ød mm	Pattern - Mønster - Mönster - Malli - Muster - Modello - модель - Taille	m kg
160	300	-
200	400	-
250	500	-
315	600	-

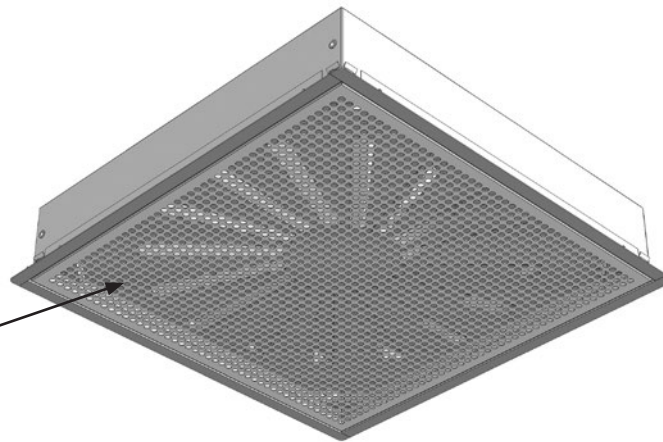
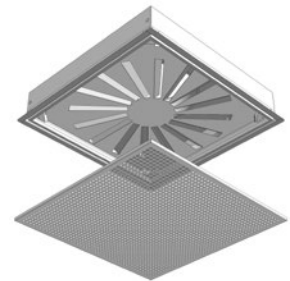

Pattern - Page 4  
 Mønster - Side 4  
 Mönster - Sida 4  
 Malli - Sivu 4  
 Muster - Seite 4  
 Modello - Pagina 4  
 модель - страница 4  
 Taille - voir page 4

Symbols  
 Symboler  
 Symboler  
 Symbolit  
 Symbole  
 Simboli  
 Обозначения  
 Symboles

S  Supply air  
 Indblæsning  
 Tilluft  
 Sisäänpuhallus  
 Zuluft  
 Aria di mandata  
 Приточная вентиляция  
 Soufflage



# Versio-V

# PS8-V - PS11-V

Rotation insert  
 Rotations indsats  
 Rotationsinsats  
 Rotation insert FIN  
 Rotation insert DE  
 Rotation insert ITA  
 Rotation insert RUS  
 Effet hélicoïdal

**B**

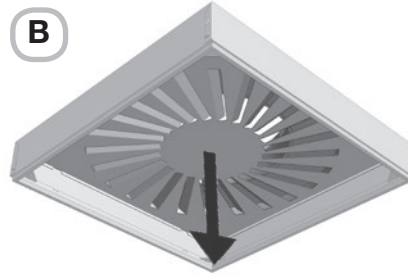

**A**

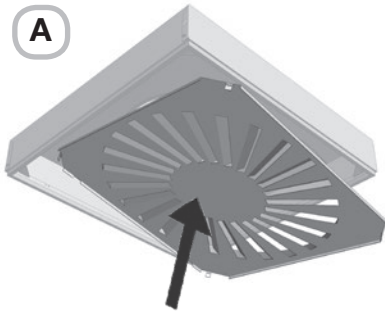

**C**

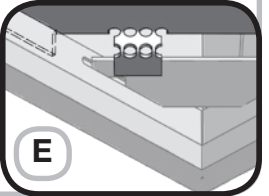
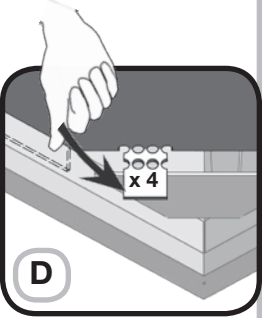
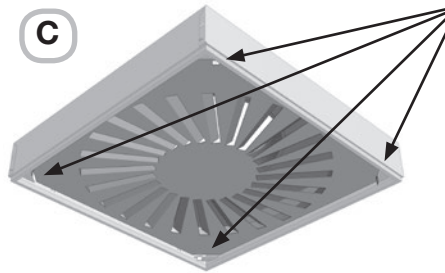

- |            |   |                          |
|------------|---|--------------------------|
| Demounting | - | Follow step E - A        |
| Demounting | - | Følg trin E - A          |
| Demounting | - | Följ steg E - A          |
| Irrotus    | - | Follow step E - A - FIN  |
| Demontage  | - | Folgen Sie Schritt E - A |
| Smontaggio | - | Seguire punto E - A      |
| Демонтаж   | - | Step E -A - RUS          |
| Demontage  | - | Suivre les étapes E - A  |

Order code  
 Bestillings kode  
 Beställningskod  
 Tilauskoodi  
 Bestellcode  
 Ordinazione  
 Код Заказа  
 Codification

Only supply air - Kun Indblæsning - Kun Tilluft  
 Vain Sisäänpuhallus - Nur Zuluft - Solo Aria di mandata -  
 только Приточная вентиляция - Seulement Soufflage

PSX	V	S	0	XXX	X
PS8 		S	UK - No damper / No pressure plate DK - Ingen spjæld / Ingen trykplade SE - Utan spjäll / Utan mättryckplatta FI - Ei mitään vaimenninta / Ei-paine-lautanen DE - Keine Meß- / Drosseleinrichtung. IT - Nessun di pressione nessun/ Più umido piatto RU - Без регулятора/Без клапана балансировки FR - Pas de registre / pas de prise de pression	ø160 ø200 ø250 ø315	1 - 22  Ceiling type no. Lofttype nr. Undertaks typ nr. Alakaton tyyppi nro. Deckentyp Nr. Tipo di soffitto n. Тип потолка № Plafond type n°
PS9 					
PS10 					
PS11 					

page 4 - side 4 - sida 4 -  
 sivu 4 - Seite 4 pagina 4 -  
 страница 4 - Page 4





# Versio-V

# RS14-V

Measure / weight  
 Mål / vægt  
 Mått / vikt  
 Mitta / paino  
 Abmessungen / Gewicht  
 Misure / peso  
 Размер / вес  
 Dimensions / Poids

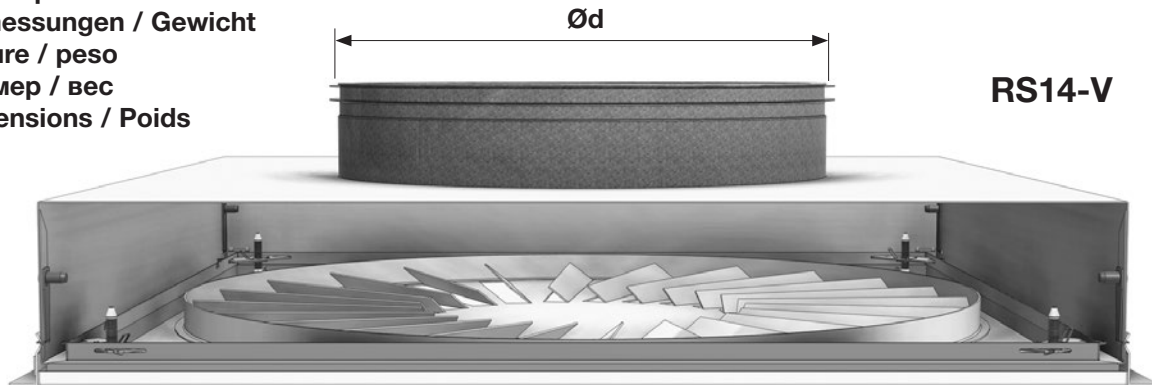

Ød mm	Pattern - Mønster - Mönster - Malli - Muster - Modello - модель - Taille	m kg
160	400	-
200	400	-
250	500	-
315	600	-

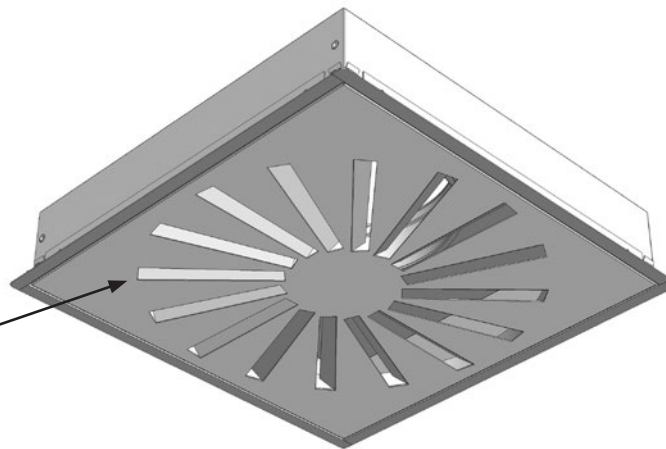

Pattern - See page 4  
 Mønster - Se side 4  
 Mönster - Se sida 4  
 Malli - See page 4  
 Muster - Siehe Seite 4  
 Modello - See page 4  
 модель - See page 4  
 Taille - voir page 4

**Symbols**  
**Symboler**  
**Symboler**  
**Symbolit**  
**Symbole**  
**Simboli**  
**Обозначения**  
**Symboles**

**S**  Supply air  
 Indblæsning  
 Tilluft  
 Sisäänpuhallus  
 Zuluft  
 Aria di mandata  
 Приточная вентиляция  
 Soufflage

**E**  Exhaust air  
 Udsugning  
 Frånluft  
 Poistoilma  
 Abluft  
 Aria di estrazione  
 Вытяжная вентиляция  
 Extraction



# Versio-V

# RS14-V

Order code  
 Bestillings kode  
 Beställningskod  
 Tilauskoodi  
 Bestellcode  
 Ordinazione  
 Код Заказа  
 Codification

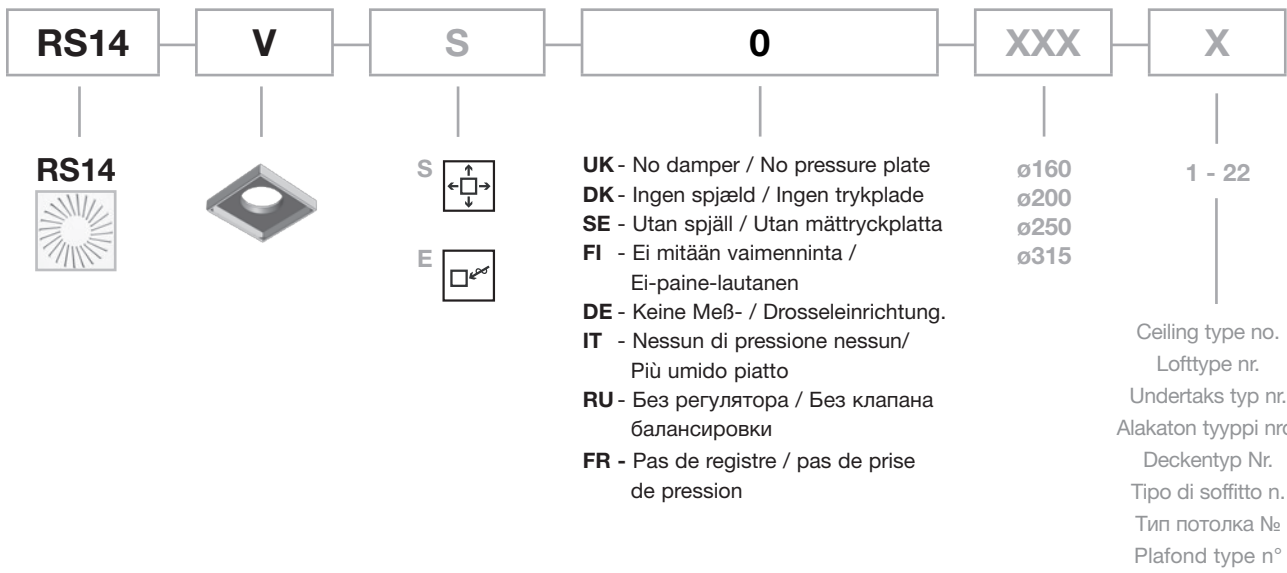

page 4 - side 4 - sida 4 -  
 sivu 4 - Seite 4 pagina 4 -  
 страница 4 - Page 4







# Versio-V

# RS15-V - RS16-V

Measure / weight  
 Mål / vægt  
 Mått / vikt  
 Mitta / paino  
 Abmessungen / Gewicht  
 Misure / peso  
 Размер / вес  
 Dimensions / Poids

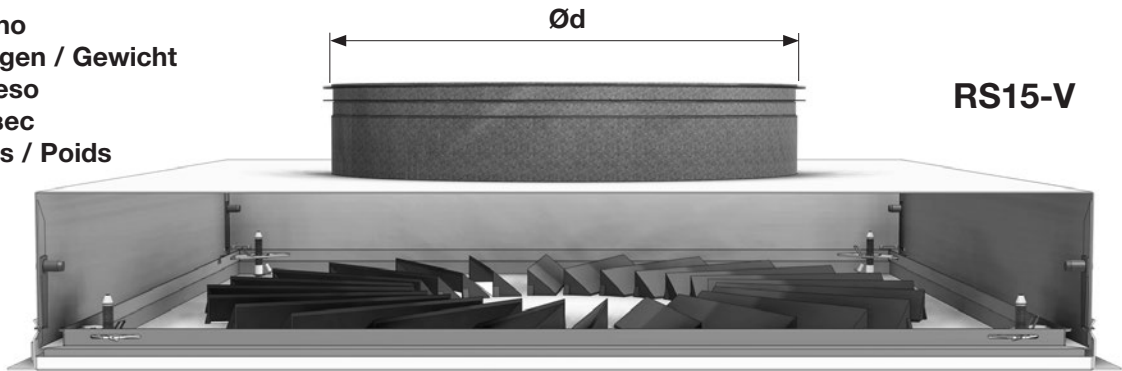

**RS15-V**

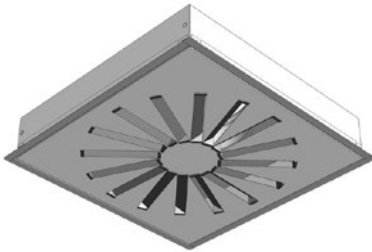

Ød mm	Pattern - Mønster - Mönster - Malli - Muster - Modello - модель - Taille	m kg
200	400	-
250	500	-
315	600	-

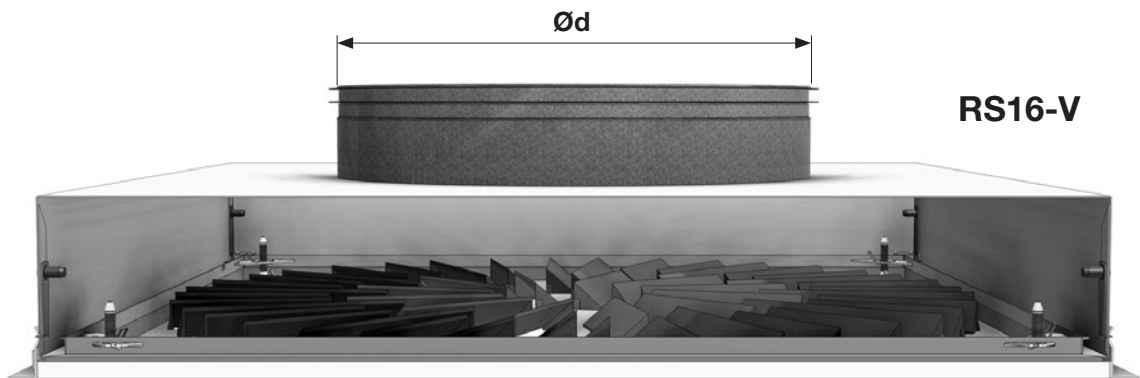

**RS16-V**

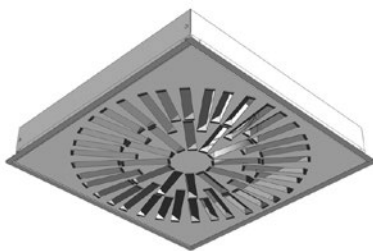

Ød mm	Pattern - Mønster - Mönster - Malli - Muster - Modello - модель - Taille	m kg
315	600	-

Symbols  
 Symboler  
 Symboler  
 Symbolit  
 Symbole  
 Simboli  
 Обозначения  
 Symboles

**S**  Supply air  
 Indblæsning  
 Tilluft  
 Sisäänpuhallus  
 Zuluft  
 Aria di mandata  
 Приточная вентиляция  
 Soufflage

**E**  Exhaust air  
 Udsugning  
 Frånluft  
 Poistoilma  
 Abluft  
 Aria di estrazione  
 Вытяжная вентиляция  
 Extraction



# Versio-V

# RS15-V - RS16-V

Supply air / Exhaust air  
 Indblæsning / Udsugning  
 Tilluft / Frånluft  
 Sisäänpuhallus / Poistoilma  
 Zuluft / Abluft  
 Aria di mandata / Aria di estrazione  
 Приточная вентиляция / Вытяжная вентиляция  
 Soufflage / Extraction

RS15-V-S

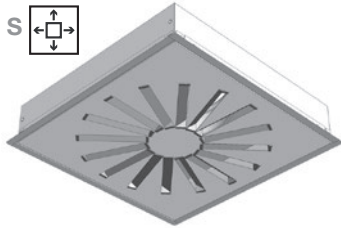

RS16-V-S

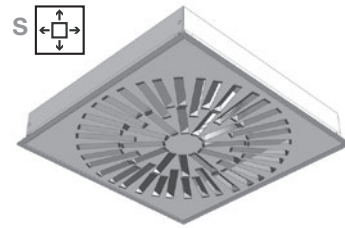

RS15-V-E

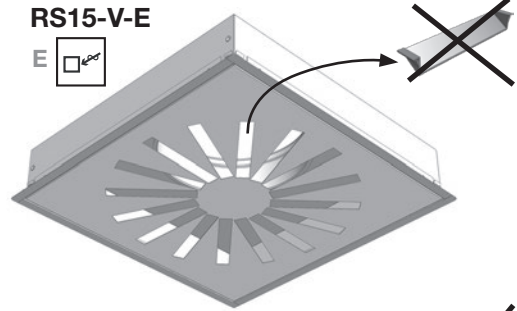

RS16-V-E

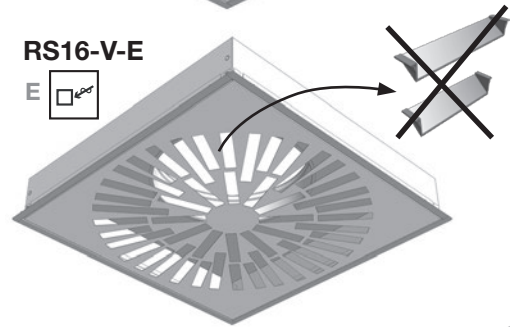

Order code  
 Bestillings kode  
 Beställningskod  
 Tilauskoodi  
 Bestellcode  
 Ordinazione  
 Код Заказа  
 Codification

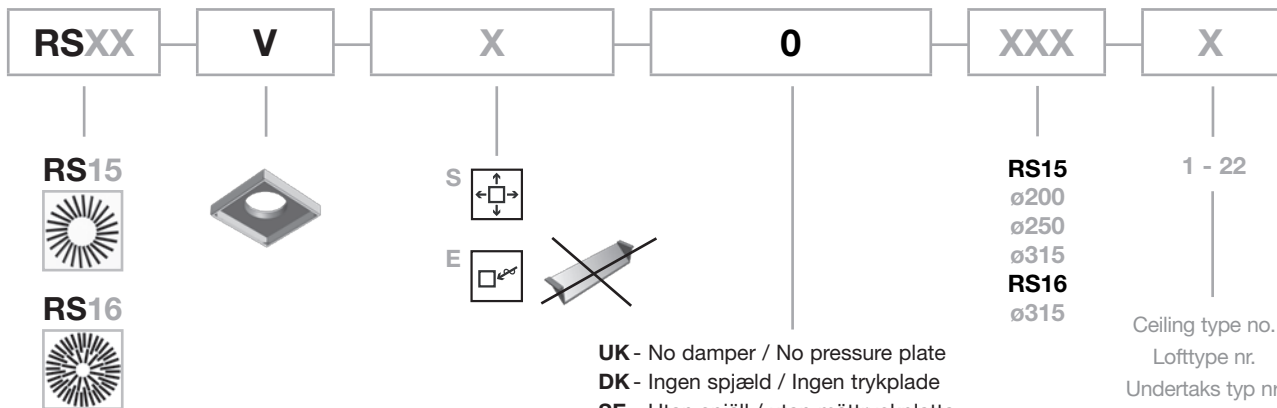

UK - No damper / No pressure plate  
 DK - Ingen spjæld / Ingen trykplade  
 SE - Utan spjäll / utan mättryckplatta  
 FI - Ei mitään vaimenninta /  
 Ei-paine-lautanen  
 DE - Keine Meß- / Drosseleinrichtung.  
 IT - Nessun di pressione nessun/  
 Più umido piatto  
 RU - Без регулятора / Без клапана  
 - балансировки  
 FR - Pas de registre / pas de prise  
 de pression

page 4 - side 4 - sida 4 -  
 sivu 4 - Seite 4 pagina 4 -  
 страница 4 - Page 4





# Versio-V

# RS15-V - RS16-V

**Supply air - Adjustable bars**  
**Indblæsning - Stilbare lameller**  
**Tilluft - Ställbara lameller**  
**Sisäänpuhallus - Adjustable bars FIN**  
**Zuluft - Verstellbaren Lamellen**  
**Aria di mandata - Deflettori regolabili**  
**Приточная вентиляция - Adjustable bars RUS**  
**Soufflage - déflecteurs réglables**

Example - Eksempel - Exempel  
 Esimerkki - Beispiel - Esempio  
 Пример - Exemple

RS15  
 S

RS15



- Standard - Inward swirl
- Standard - Indadvendt rotation
- Standard - Inåtvänd rotation
- Standard - Pyörrehajotin sisääpäin
- Standard - Innendrall
- Standard - Rotazione verso l'interno
- Standard - Вихревой 'в центр'
- Standard - Rotation intérieure

RS15

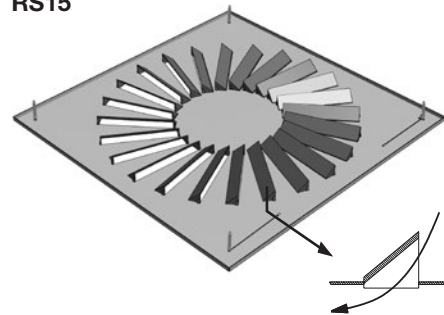

RS15



- Outward swirl
- Udadvendt rotation
- Utåtvänd rotation
- Pyörrehajotin ulospäin
- Außendrall
- Rotazione verso l'esterno
- Вихревой 'от центра'
- Rotation extérieure

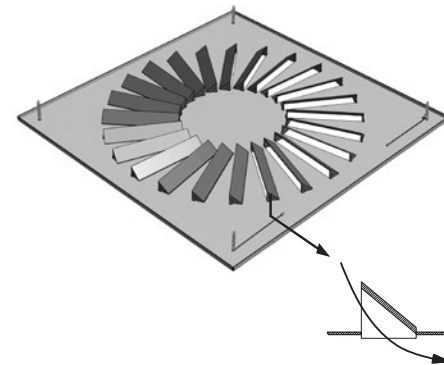

RS15



- Vertical supply air
- Vertikal Indblæsning
- Vertikal inblåsning
- Pystysuora puhallus
- Vertikale Luftzufuhr
- Immissione dell'aria in direzione verticale
- Вертикальная приточная вентиляция
- Soufflage vertical

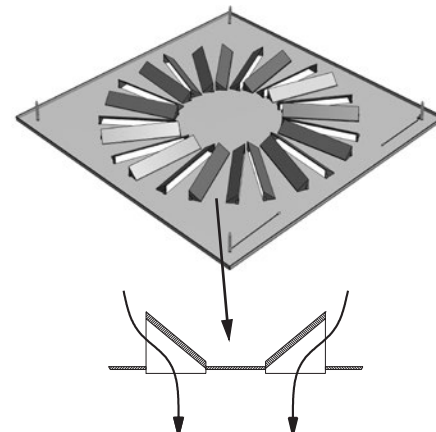



# Versio-V

# NS19-V

Measure / weight  
 Mål / vægt  
 Mått / vikt  
 Mitta / paino  
 Abmessungen / Gewicht  
 Misure / peso  
 Размер / вес  
 Dimensions / Poids

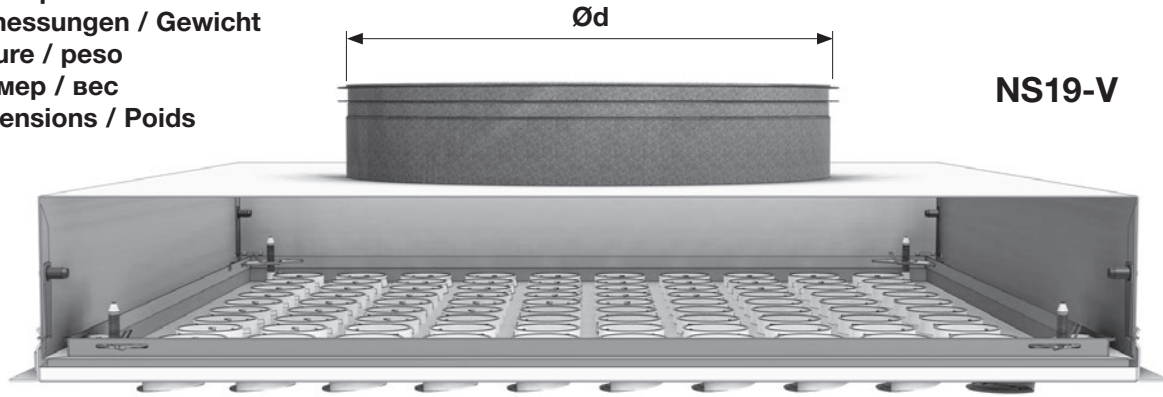

Ød mm	Pattern - Mønster - Mönster - Malli - Muster - Modello - модель - Taille	m kg
160	300	-
200	400	-
250	500	-
315	600	-

Pattern - See page 4  
 Mønster - Se side 4  
 Mönster - Se sida 4  
 Malli - See page 4  
 Muster - Siehe Seite 4  
 Modello - See page 4  
 модель - See page 4  
 Taille - voir page 4

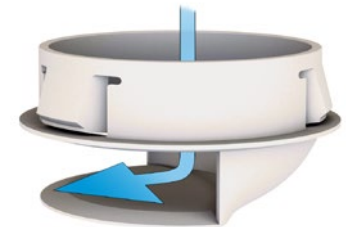

## Symbols Symboler Symboler Symbolit Symbole Simboli Обозначения Symboles



Standard - Rotation  
 Standard - Rotation  
 Standard - Rotation  
 Standard - Pyörrevirta  
 Standard - Drall ( Rotation )  
 Standard - Rotazionale  
 Standard - Вихревой  
 Standard - Hélicoïdal



4 - way  
 4 - vejs  
 4 - vägs  
 4 - suuntaa  
 4 - seitig  
 4 - vie  
 4 - сторонний  
 4 - directions



3 - way  
 3 - vejs  
 3 - vägs  
 3 - suuntaa  
 3 - seitig  
 3 - vie  
 3 - сторонний  
 3 - directions



2 - way  
 2 - vejs  
 2 - vägs  
 2 - suuntaa  
 2 - seitig  
 2 - vie  
 2 - сторонний  
 2 - directions



1 - way  
 1 - vejs  
 1 - vägs  
 1 - suuntaa  
 1 - seitig  
 1 - via  
 1 - сторонний  
 1 - direction



2 - way corner  
 2 - vejs hjørne  
 2 - vägs hörn  
 2 - suuntaa, nurkka  
 2 - seitig über Eck  
 2 - vie Angolare  
 2-сторонний угловой  
 2 - directions coin



Vertical supply air  
 Vertikal indblæsning  
 Vertikal inblåsning  
 Pystysuora puhallus  
 Vertikale luftzufuhr  
 Immissione dell'aria in direzione verticale  
 Вертикальная приточная вентиляция  
 Soufflage vertical



# Versio-V

# NS19-V

Order code  
Bestillings kode  
Beställningskod  
tilauskoodi  
Bestellcode  
Ordinazione  
Код Заказа  
Codification

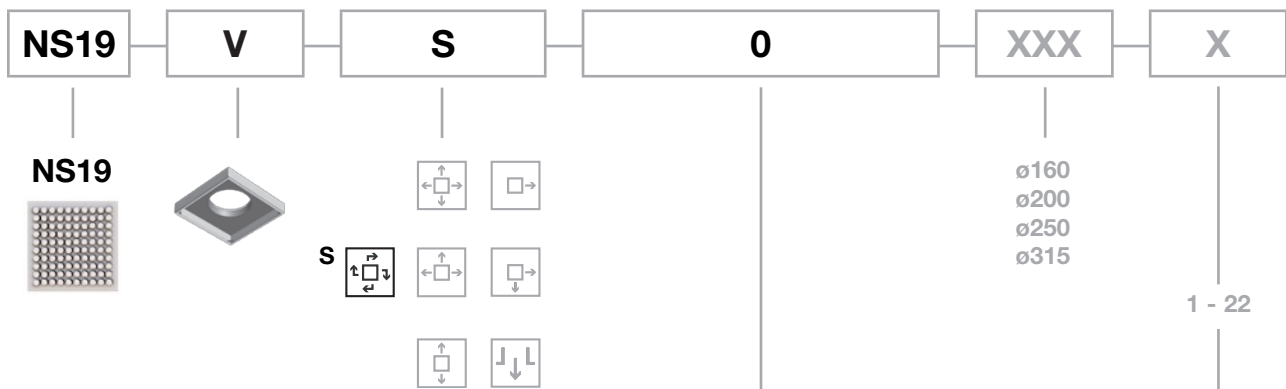

**UK** - No damper / No pressure plate  
**DK** - Ingen spjæld / Ingen trykplade  
**SE** - Utan spjäll / Utan mättryckplåt  
**FI** - Ei mitään vaimenninta /  
 Ei-paine-lautanen  
**DE** - Keine Meß- / Drosseleinrichtung.  
**IT** - Nessun di pressione nessun/  
 Più umido piatto  
**RU** - Без регулятора/Без клапана  
 балансировки  
**FR** - Pas de registre / pas de prise  
 de pression

Ceiling type no.  
 Lofttype nr.  
 Undertaks typ nr.  
 Alakaton tyyppi nro.  
 Deckentyp Nr.  
 Tipo di soffitto n.  
 Тип потолка №  
 Plafond type n°

Page 4 - side 4 - sida 4  
 sivu 4 - Seite 4  
 pagina 4 - страница 4





# Versio-V

# NS19-V

**Air patterns - Individually adjustable nozzles**  
**Luftmønstre - Individuelt stilbare dyser**  
**Dysinställning - Individuellt ställbara dysor**  
**Suuttimien säätö - Individually adjustable nozzles FIN**  
**Luftführung - Einzel einstellbaren Düsen**  
**Tipologia di lancio - Ugelli singolarmente regolabili**  
**Направление струи - Individually adjustable nozzles RUS**  
**Profilis de soufflage - buses individuelles ajustables**

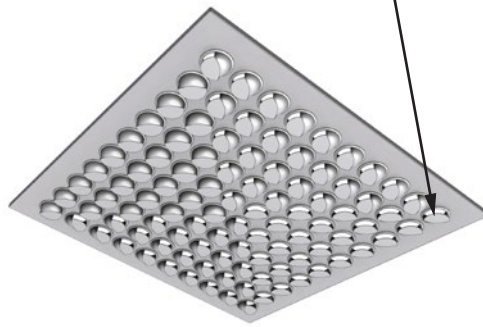
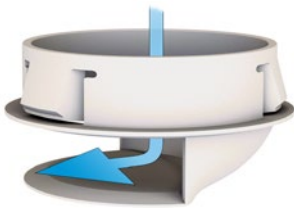
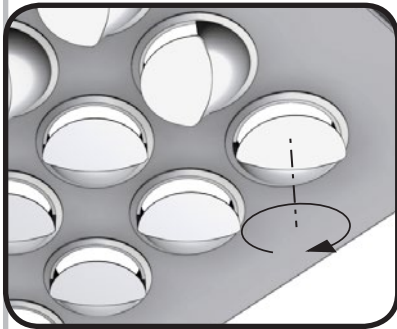

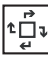
- S**  Standard - Rotation  
 Standard - Rotation  
 Standard - Rotation  
 Standard - Pyörrevirta  
 Standard - Drall ( Rotation )  
 Standard - Rotazionale  
 standard - Вихревой  
 Standard - Hélicoïdal

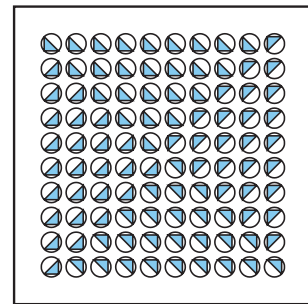

**S** 

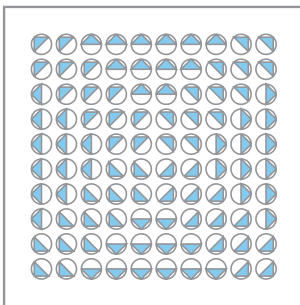

**S** 

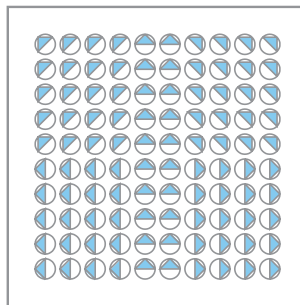

**S** 

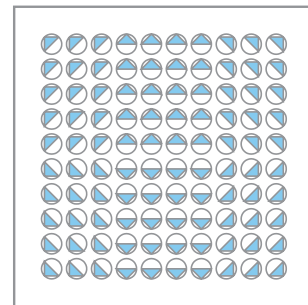

**S** 

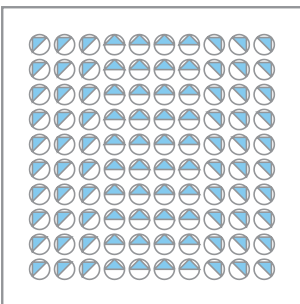

**S** 

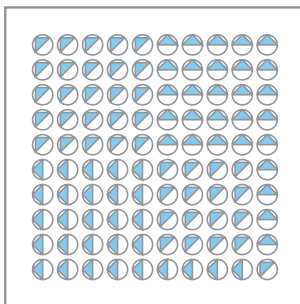

**S** 

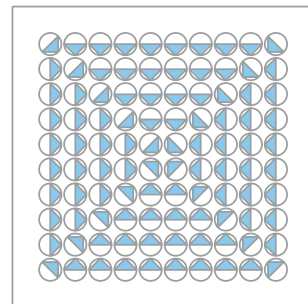



# Versio-V

# GS23-V

Measure / weight  
 Mål / vægt  
 Mått / vikt  
 Mitta / paino  
 Abmessungen / Gewicht  
 Misure / peso  
 Размер / вес  
 Dimensions / Poids

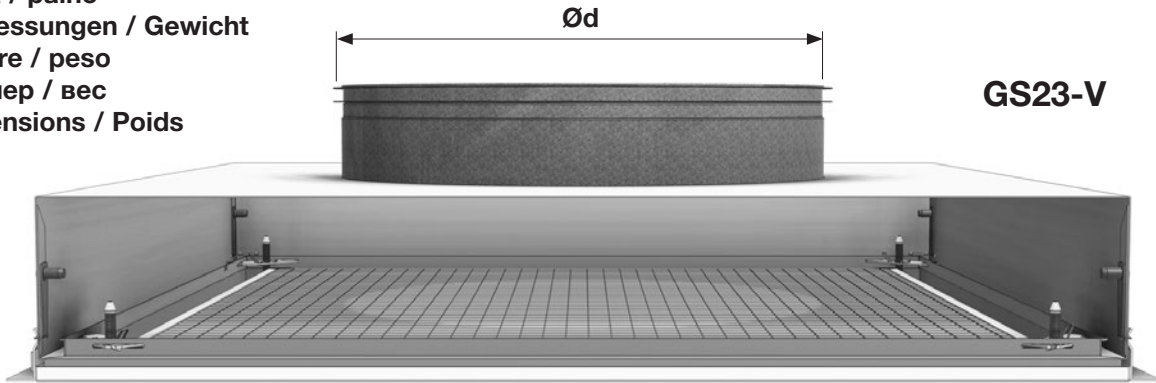

**GS23-V**

Ød mm	Pattern - Mønster - Mönster - Malli - Muster - Modello - модель - Taille	m kg
160	300	-
200	400	-
250	500	-
315	600	-

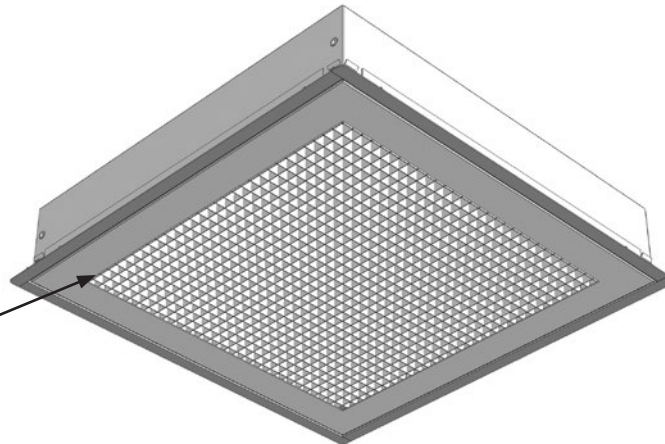

Pattern - See page 4  
 Mønster - Se side 4  
 Mönster - Se sida 4  
 Malli - See page 4  
 Muster - Siehe Seite 4  
 Modello - See page 4  
 модель - See page 4  
 Taille - voir page 4

**Symbols**  
**Symboler**  
**Symboler**  
**Symbolit**  
**Symboler**  
**Simboli**  
**Обозначения**  
**Symboles**

- E**  Exhaust air  
 Udsugning  
 Frånluft  
 Poistoilma  
 Abluft  
 Aria di estrazione  
 Вытяжная вентиляция  
 Extraction



# Versio-V

# GS23-V

Order code  
 Bestillings kode  
 Beställningskod  
 Tilauskoodi  
 Bestellcode  
 Ordinazione  
 Код Заказа  
 Codification

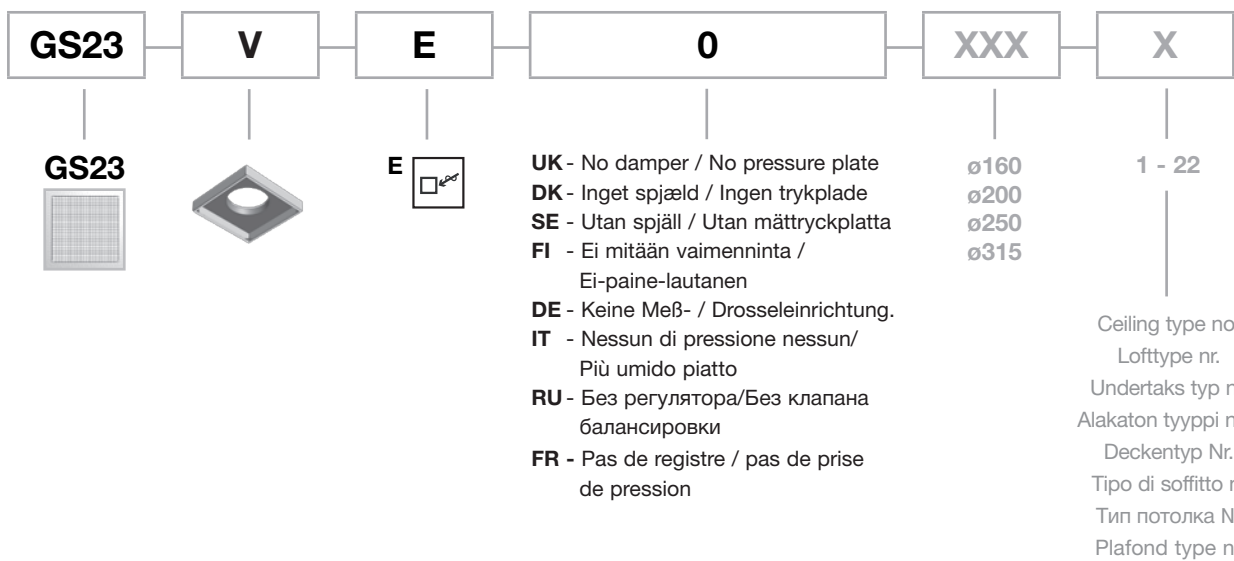

page 4 - side 4 - sida 4 -  
 sivu 4 - Seite 4 pagina 4 -  
 страница 4 - Page 4







**Support**  
**Hjælp**  
**Hjälp**  
**Tuotetuki**  
**Unterstützung**  
**Supporto**  
**Помощь**  
**Support**

**UK** - Here you can find product updates/mounting instructions and support telephone number/mail.

**www.lindab.com**

Right to alterations reserved.

**DK** - Her kan du finde seneste produkt opdateringer/ montagevejledninger samt support tlf. nr/mail.

**www.lindab.dk**

Ret til ændringer forbeholdes.

**SE** - Här kan du alltid hitta senaste produktuppdateringarna/montageanvisningarna samt support tel. /e-mail.

**www.lindab.se**

Rätt till ändringar förbehålles.

**FI** - Täältä löydät uusimmat tuotetiedot ja asennusohjeet sekä tuotetuen yhteystiedot.

**www.lindab.fi**

Oikeus muutoksiin pidätetään.

**DE** - Hier finden Sie aktuelle Produktinformationen/ Montageanleitungen und Telefonnummer/ E-Mail-Adressen der Ansprechpartner.

**www.lindab.de**

Änderungen vorbehalten.

**IT** - Qui potete trovare istruzioni di montaggio, informazioni sul prodotto ed un supporto tecnico qualificato  
Tel. 011 9952099 - e-mail: lindab@lindab.it

**www.lindab.it**

Soggetto a modifica senza obbligo di preavviso.

**RU** - Здесь вы можете найти обновления изделия/ инструкции по монтажу и техн. поддержку по тел. / электронной почте.

**www.lindab.ru**

Сохраняется право на внесение изменений

**FR** - Vous trouverez les fiches produits ou de montage actualisées ainsi que les coordonnées du support téléphonique à l'adresse suivante :

**www.lindab.fr**

Toutes modifications réservées.

**Do you have trouble finding your local contacts  
please go to:**

**www.lindab.com**

**VERSIO-V-27052014**