



INTEGRA

Ø315

PC6, PC7, RC14, RC15, NC19

Mounting instruction
Montage vejledning
Montageanvisning
Asennusohje
Montageanweisung
Istruzioni di montaggio
Инструкция по монтажу

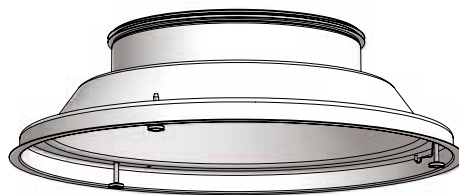
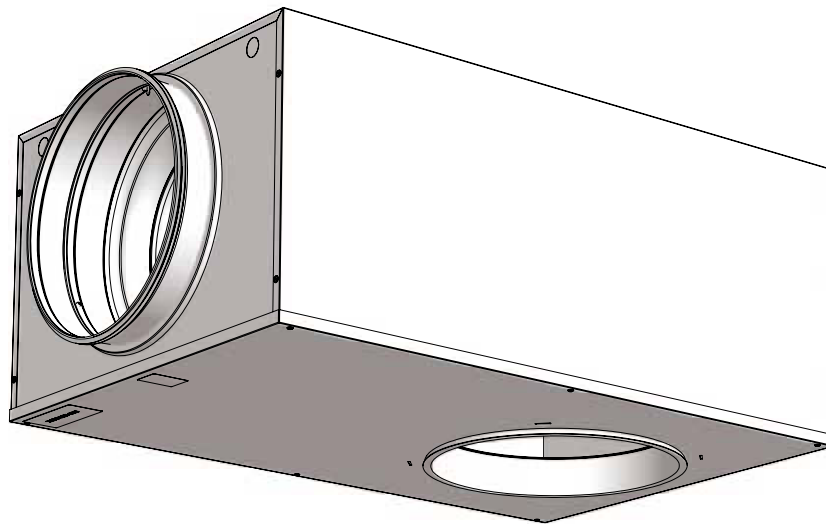



INTEGRA Ø315 PC6, PC7, RC14, RC15, NC19

Integra størrelse 315 - ingen huller for montage i MBB
Integra size 315 - No holes for mounting in MBB
Integra Größe -315 - keine löcher für montage im MBB

Ingen huller !
No holes !
Keine löcher

PC6, PC7,
 RC14, RC15, Ø315
 NC19

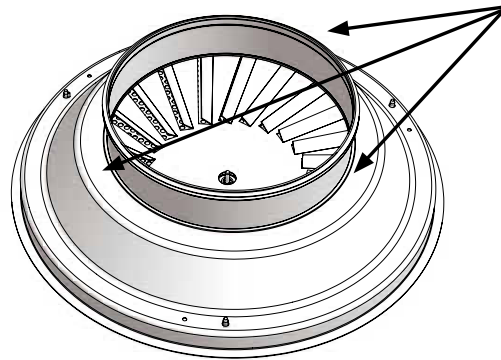

Demontering af bundplade / rotationsindsats
Demounting of faceplate / Swirl insert
Frontplatte / Drallelement demontieren

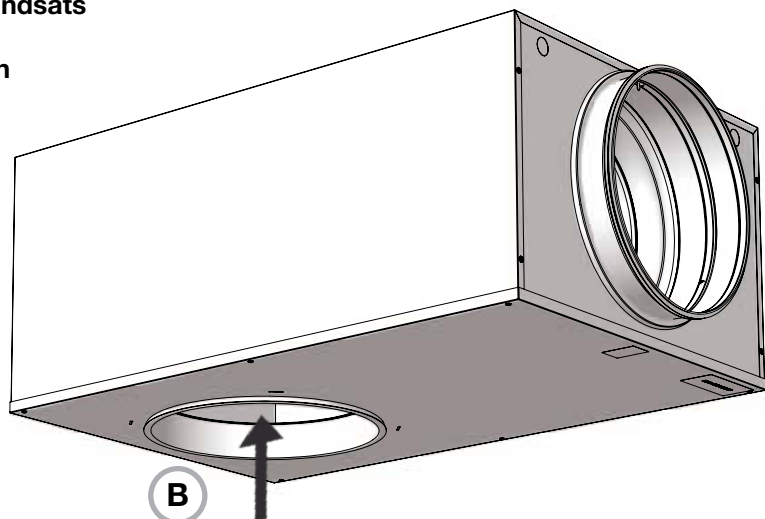

Service wires
 Service wirer
 Service vajror
 Huoltovaijerit
 Service Drähte
 Cavi per manutenzione
 Сервисный трос

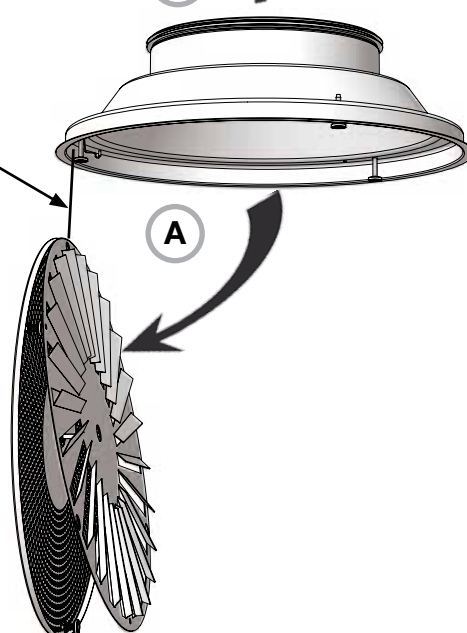

 **No tools - Magnet**
Ingen værktøj - Magnet
Inga verktyg - Magnet
Ei työkaluja - Magneetit
Keine Werkzeuge - Magnet
Nessun attrezzo - Magnete
Без инструмента - магнит



INTEGRA Ø315 PC6, PC7, RC14, RC15, NC19

Montering af PC7 + MBB
Mounting of PC7 + MBB
PC7 + MBB Montage

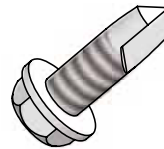
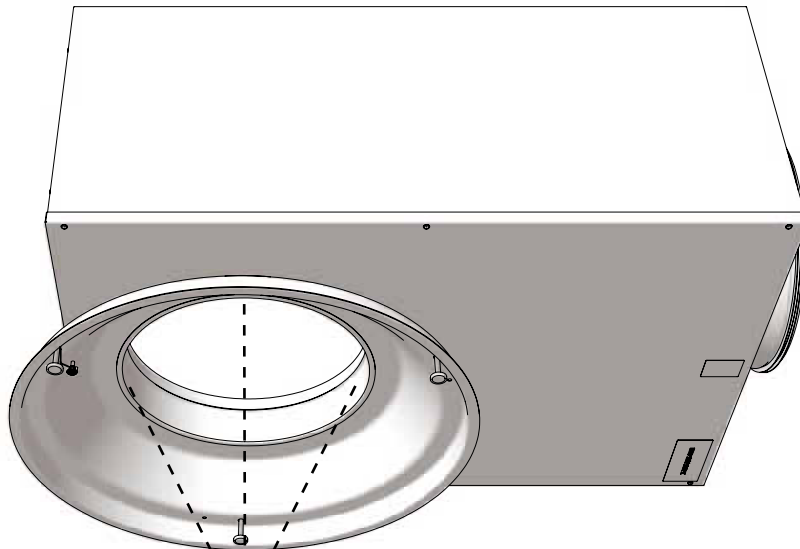

Selvskærende skrue x3
Self tapping screws x3
Blehschrauben x3

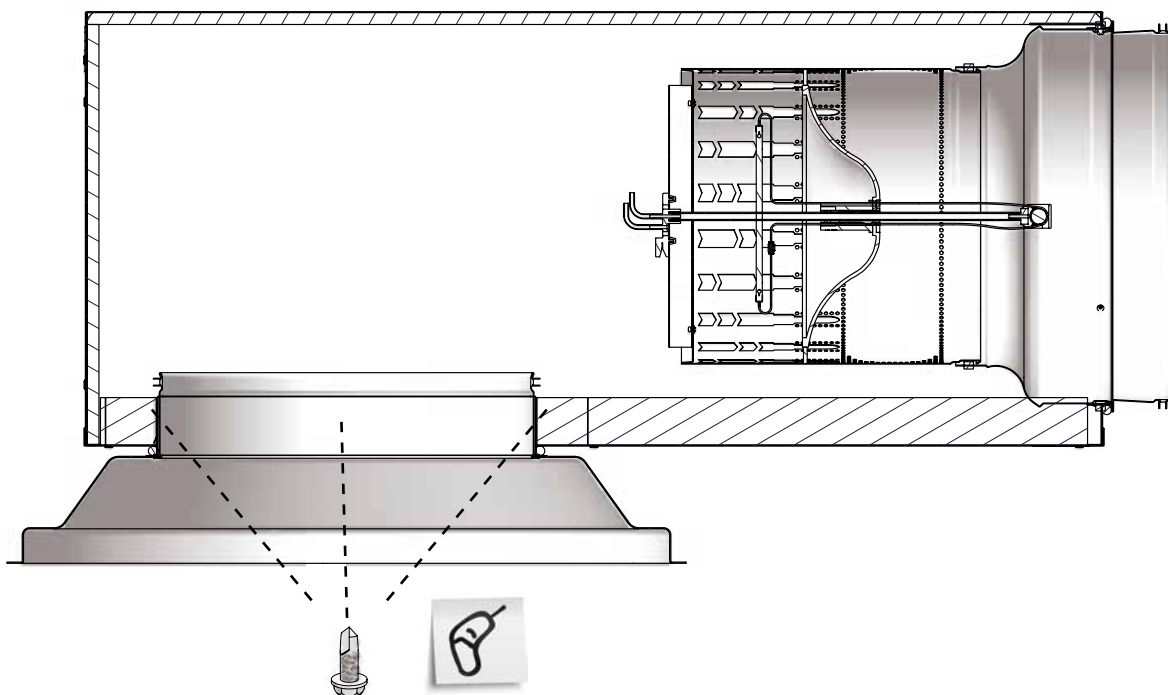



Support
Hjælp
Hjälp
Tuotetuki
Unterstützung
Supporto
Помощь

UK - Here you can find product updates/mounting instructions and support telephone number/mail.

www.lindab.com

Right to alterations reserved.

DK - Her kan du finde seneste produkt opdateringer/ montagevejledninger samt support tlf. nr/mail.

www.lindab.dk

Ret til ændringer forbeholdes.

SE - Här kan du alltid hitta senaste produktuppdateringarna/montageanvisningarna samt support tel. /e-mail.

www.lindab.se

Rätt till ändringar förbehålles.

FI - Täältä löydät uusimmat tuotetiedot ja asennusohjeet sekä tuotetuen yhteystiedot.

www.lindab.fi

Oikeus muutoksiin pidätetään.

DE - Hier finden Sie aktuelle Produktinformationen/ Montageanleitungen und Telefonnummer/ E-Mail-Adressen der Ansprechpartner.

www.lindab.de

Änderungen vorbehalten.

IT - Qui potete trovare istruzioni di montaggio, informazioni sul prodotto ed un supporto tecnico qualificato
Tel. 011 9952099 - e-mail: lindab@lindab.it

www.lindab.it

Soggetto a modifica senza obbligo di preavviso.

RU - Здесь вы можете найти обновления изделия/ инструкции по монтажу и техн. поддержку по тел. / электронной почте.

www.lindab.ru

Сохраняется право на внесение изменений

**Do you have trouble finding your local contacts
please go to:**

www.lindabcomfort.com

INTEGRA-Ø315-PC6-7-RC-14-15-NC19-12052010



www.lindabcomfort.com