

Plenum box

STB/STU



Description

STB is a rectangular plenum box for supply air for linear diffuser, MTL. The plenum box ensures even distribution over the linear diffuser. STB is equipped with a damper and an orifice plate to ensure individual regulation, and is supplied with acoustic insulation.

STU is a rectangular plenum box for air exhaust for linear diffuser, MTL. STU has the same properties as STB.

- Ensures even air distribution over the linear diffuser.
- Acoustically insulated.
- Supplied with damper and measuring device

Maintenance

Cleaning of STB/STU is made more difficult because of the narrow space between slots. We therefore recommend that you ensure there are alternative cleaning options for the duct. To gain access to the box, the linear diffuser must be removed, as well as the plenum plate in the case of STB.

Order code

| | | | | |
|----------------|----------------|----------|----------|------------|
| Product | STB/STU | a | a | ccc |
| Type | | | | |
| Slot size | 15 | | | |
| | 19 | | | |
| No. of slots | | | | |
| Length (L) | | | | |

Dimensions

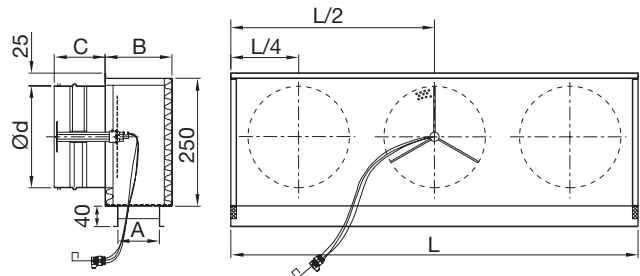

C dimension: STB = 100 mm
STU = 200 mm

| Box type / Length | 1200-1799 | | | | | | 1800-2000 | | | |
|-------------------|-----------|-----|-----|-----|-----------------------|---|-----------|---|-----|---|
| | Slot size | | | | Number of connections | | | | | |
| No. of slots | 15 | | 19 | | Ød | | Ød | | Ød | |
| | A | B | A | B | | | | | | |
| 1 | 26 | 90 | 41 | 91 | 125 | 1 | 160 | 1 | 125 | 2 |
| 2 | 51 | 100 | 80 | 130 | 160 | 1 | 200 | 1 | 160 | 2 |
| 3 | 76 | 125 | 118 | 168 | 200 | 1 | 200 | 2 | 200 | 2 |
| 4 | 101 | 150 | 158 | 208 | 200 | 1 | 200 | 2 | 200 | 2 |

Materials and finish

Plenum box: Galvanised steel
Standard finish: Galvanised steel
Insulation: Melamine foam plastic

