

Regulating damper

DRU

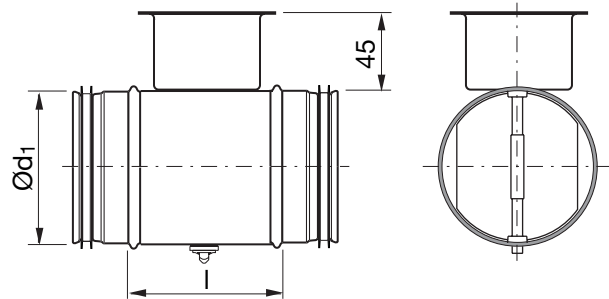

Dimensions



Description

Has a turning, cut-off blade. The blade is stepless adjustable 0–90°. The damper admits an insulation thickness of approx. 50 mm.

The blade is designed to generate a minimum of noise. The noise is approx. the same as for a perforated blade. But the blade is less sensitive to clogging since it lacks perforations.

Setting the blade angle at the rim of the cup (α)

$\alpha = 0^\circ$ = open blade

$\alpha = 90^\circ$ = closed blade

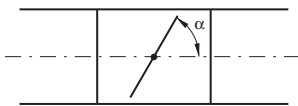

There is a separate assembly, measuring, balancing and maintenance instruction for this product.

Ø 80–1000 fulfills pressure class A in closed position.

The cup at Ø 80–630 can be complemented with the special insulation cup IK at insulation thicker than 50 mm.

Ød ₁ nom	l mm	m kg	Sealing class past closed blade
80	100	0,34	0
100	100	0,40	0
125	100	0,46	0
160	100	0,65	0
180	100	0,69	0
200	100	0,80	0
224	100	0,90	0
250	100	1,28	0
315	100	1,70	0

Order code

