

Lindab **UltraLink[®] Monitor** **FTMU**

Montageanvisning 3.5



Vær opmærksom på:

- Fjern ikke målesensorerne
- Anvend ikke målesensorerne som håndtag ved montage af FTMU, idet disse kan blive beskadiget!



- Sørg for, at pilen for volumenstrøm peger i luftens bevægelsesretning.

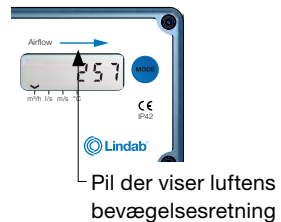

- Roter kanalstykket med målesensorerne til korrekt position som vist på næste side.

- Placer Displayet så det let kan aflæses. Ved at løsne møtrikken på stålspændebåndet kan displayenheden roteres.



- Monter FTMU i kanalsystemet i henhold til [montagevejledning for Lindab Safe](#).



- Placer aldrig FTMU i afgangskanalen fra en kanalventilator. Placer enheden på indtagsiden eller i værste fald skal en luftensretter placeres på afkastsiden før FTMU enheden.
- Længst mulig afstand til en forhindring dvs. længst mulig lige kanalstrækning før UltraLink®, vil give den største nøjagtighed af luftmængdemålingen.

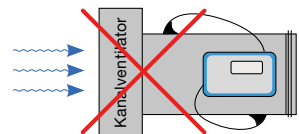

Vær opmærksom på:

- Bemærk ID-number for FTMU. ID nummeret er de sidste tre cifre i serienummeret der kan findes:
 - på label der er påklisteret kassen som enheden bliver leveret i
 - på den label der er fastgjort direkte på FTMU
 - i displayet efter at have trykket på “MODE” knappen
 - i UltraLink Appen hvis enheden er tilkoblet

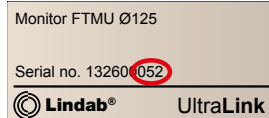
**Placering**

Forhindring	* Placering af første målesensor	Måleusikkerhed ± % eller 1 l/s afhængig af hvad der er størst			
		A			
		2-4xØd	>4-5xØd	>5xØd	
Bøjning		Indvendig radius (Bedste placering)	5	5	5
T-stykke		Indvendig radius (Bedste placering)	10	5	5
Reduktion		Rørdimension reduceres	5	5	5
Reduktion		Rørdimension øges	10	5	5

Declaration of conformity and FCC statement

1. Declaration number	1001
2. Unique identification code of the product	FTMU
3. Type	Ultrasonic device
4. Product description	Measuring and communicating air flow and temperature
5. Manufacturer	Lindab Ventilation AB Stålhögavägen 115, 26982 Båstad, Sweden Telephone +46 431 85000, www.lindab.com

Developed, designed and manufactured with the essential requirements by safe and security of the European Directive(s) and Regulation(s):	
2004/108/EC	Electromagnetic Compatibility Directive (EMC)
2011/65/EU & 2015/863/EC	Restriction of Hazardous Substances (RoHS)

The partly completed machinery is developed, designed and manufactured with the essential requirements of the following standards:	
EN 61000-6-1:2002 - Part 6-1	Generic standards - Immunity for residential, commercial and light-industrial environments
EN 61000-6-2:2005 - Part 6-2	Generic standards - Immunity for industrial environments
EN 61000-6-3:2002 - Part 6-3	Generic standards - Emission standard for residential, commercial and light-industrial environments
EN 61000-6-4:2002 - Part 6-4	Generic standards - Emission standard for industrial environments

FCC cuation and statement
<p>This device complies with Part 15 of the FCC Rules. Operation is subject to the following two conditions: (1) this device may not cause harmful interference, and (2) this device must accept any interference received, including interference that may cause undesired operation. Changes or modifications not expressly approved by the part responsible for compliance could void the user's authority to operate the equipment. This equipment complies with FCC exposure limits set forth for an uncontrolled environment.</p> <p>"This equipment has been tested and found to comply with the limits for a Class B digital device, pursuant to part 15 of the FCC Rules. These limits are designed to provide reasonable protection against harmful interference in a residential installation. This equipment generates, uses and can radiate radio frequency energy and, if not installed and used in accordance with the instructions, may cause harmful interference to radio communications. However, there is no guarantee that interference will not occur in a particular installation. If this equipment does cause harmful interference to radio or television reception, which can be determined by turning the equipment off and on, the user is encouraged to try to correct the interference by one or more of the following measures:</p> <ul style="list-style-type: none"> • Reorient or relocate the receiving antenna. • Increase the separation between the equipment and receiver. • Connect the equipment into an outlet on a circuit different from that to which the receiver is connected. • Consult the dealer or an experienced radio/TV technician for help."

This declaration of conformity is established under the sole responsibility of the manufacturer identified in point 5.

Signed for and on behalf of the manufacturers by:



Authorised person:

Karel Kleinmond

Group Operations Director

2019-01-21 Karlovarska, Czech Republic